

Parts Included (LED Panel Light)

- LED Panel Light x 1

Parts Included (Suspension Mounting Kit)

- Ceiling Bracket x 3 **sold separately*
- Panel Bracket x 6
- Cable Tightener x 3
- Bracket screw x 12
- Wire cables

Product Information

- Suitable for damp locations.
- Maximum ambient temperature: 122°/50°C

Important Safety Information

CAUTION! Risk Of Electric Shock

Turn off all power prior to installation by switching off circuit breaker or removing fuse at fuse box.

- This product should be installed by a fully certified electrician in accordance with relevant federal, state and local building and electrical codes.
- Due to risk of electric shock, ensure that the main power source and circuit breakers are switched off before performing any installation or wiring procedures.
- Do not install insulation within 2 in./51mm of any part of the panel light fixture.

Installation Instructions:

Connecting the Power Supply

1. Remove the knock-out hole on the end of the LED driver box (Fig.1).
2. Run conduit with AC wiring through the hole to the LED driver and connect wiring (Fig.2).
3. Wiring connections are shown in the diagram in Fig.3.

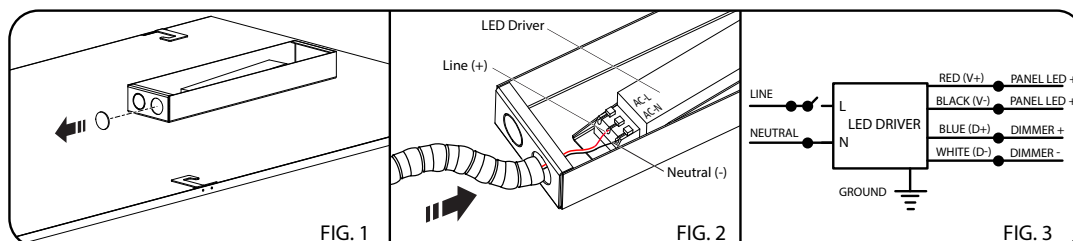

Mounting Option 1: Built-In

Suspension Hooks:

1. Pull suspension hook away from panel to a position perpendicular to the panel backing (Fig.4)
2. Bend the hook arm to a position perpendicular to the hook body (Fig.5).
3. Hook panel light onto t-bars until panel is fully supported (Fig.6).

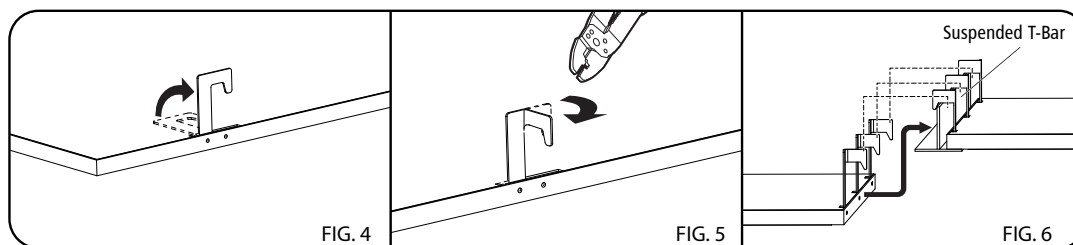

Mounting Option 2: Suspension Kit:

1. Detach the ceiling cable from the cable tightener using the release button. Mount the ceiling bracket using two screws (not included) (Fig.7).
2. Remove the suspension hook by removing the two screws, insert the panel suspension bracket into the panel slot, and re-fasten using the screws included in the kit (Fig.8). Re-thread the ceiling cable through the cable tightener until panel is suspended in desired position (Fig.9).

