

Important: Read all instructions prior to installation.

Full-Cutoff LED Wall Pack

WPSC2 Series

Installation: Mounting to Wall/Conduit

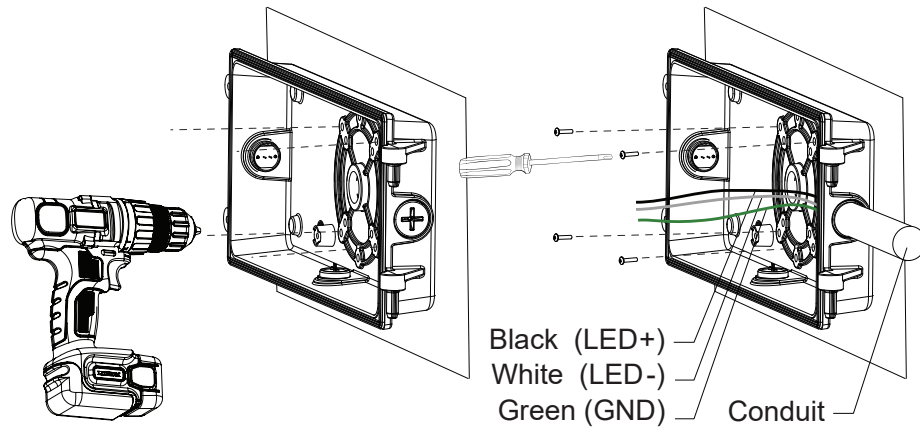

Dimensional Drawings

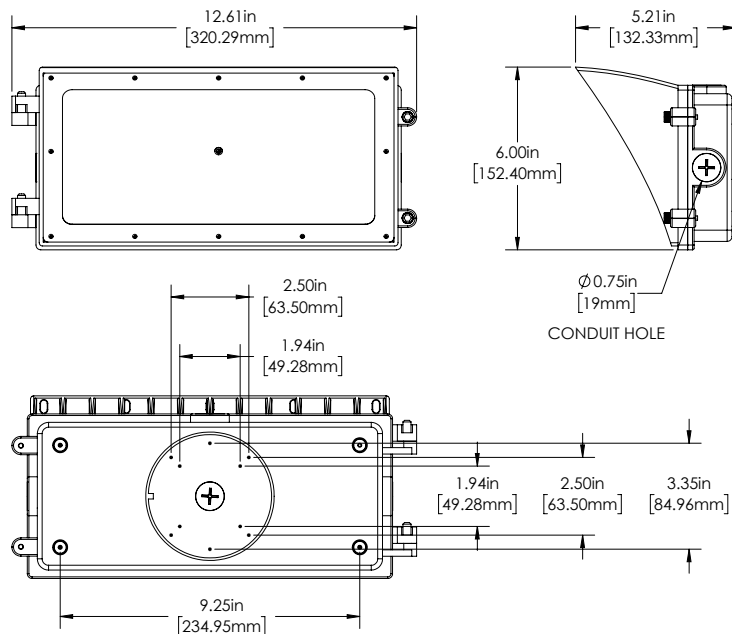

Full-Cutoff LED Wallpack

User Manual

WPSC2 Series



Important: Read all instructions prior to installation.

Full-Cutoff LED Wall Pack

Specifications

| Model | WPSC2-xK40-H | WPSC2-xK60-H | WPSC2-xK80-H |
|-----------------------|----------------------------|----------------|-----------------|
| Voltage | 120–277 VAC | | |
| Wattage | 40 W | 60 W | 80 W |
| Current | 0.33 A @120 VAC | 0.5 A @120 VAC | 0.67 A @120 VAC |
| Beam Angle | 90°x150° (NEMA 5 x NEMA 7) | | |
| Operating Temperature | -4°–104° F (-20°–40° C) | | |
| IP Rating | IP65 | | |
| Dimming | yes (1–10 V) | | |
| Warranty | 5 years | | |

Wire Diagram

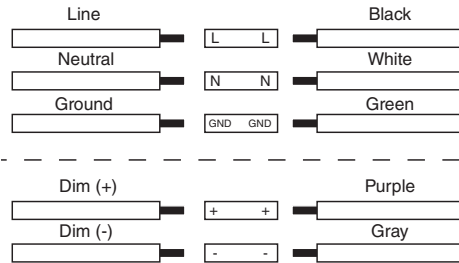

Safety Notes

- Product should be installed and serviced by a certified electrician in accordance with applicable national, state, and local building and electrical codes.
- To reduce the risk of electric shock, ensure that the main power source and circuit breakers are switched off before performing any installation or wiring procedures.
- Avoid looking directly into lamp when illuminated.
- Ensure all mounts are securely attached and will support the weight of the fixture. Failure to properly support fixture may result in damage or injury, for which the manufacturer does not assume responsibility.

Photocell Installation

Photocell can be installed into any available conduit hole. Wire according to wiring diagram.

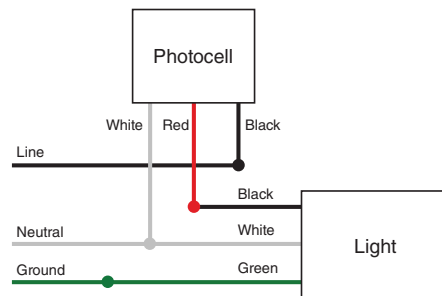

Important: Read all instructions prior to installation.

Full-Cutoff LED Wall Pack

Opening Fixture

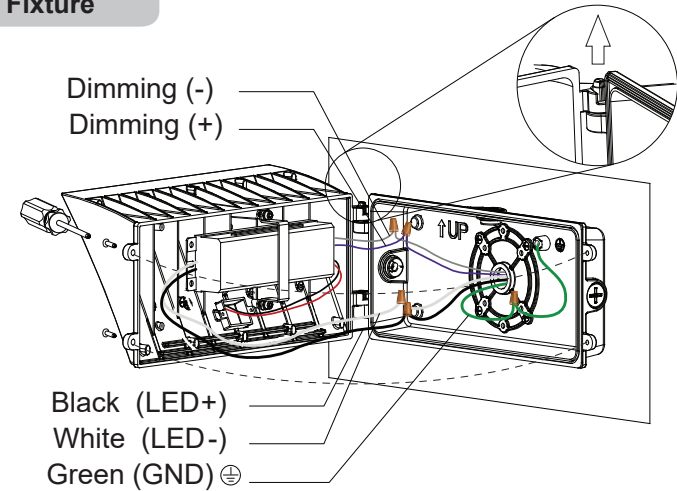

Installation: Mounting to J-box

