

Important: Read all instructions prior to installation.

WPGL Series

LED Wall Pack with Glass Lens



WPGL-xK60-H

Specifications

Model	WPGL Series
Operating Temperature	-40°–113° F (-40°–45° C)
IP Rating	IP65
Dimming	0–10 V
Photocell Operation (HPC models only)	Light will turn on when the ambient light level falls below 15 lx and will turn off when the ambient light level exceeds 60 lx.

Check product label for specific electrical specifications related to installation.
Improper installation will void warranty.

Wiring Diagram

120–277 VAC Input

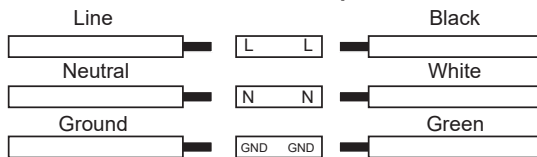

0–10 V Dimming

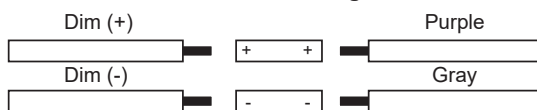

Safety and Notes

- Product should be installed and serviced by a certified electrician in accordance with applicable national, state, and local building and electrical codes.
- To reduce the risk of electric shock, ensure that the main power source and circuit breakers are switched off before performing any installation or wiring procedures.
- Avoid looking directly into lamp when illuminated.
- Ensure all mounts are securely attached and will support the weight of the fixture. Failure to properly support fixture may result in damage or injury, for which the manufacturer does not assume responsibility.
- Photocell sensor can be disabled by rewiring the light to bypass the sensor on photocell equipped models.

Opening Fixture

The fixture can be opened to bypass photocell if needed (where applicable) or to use conduit wiring through one of the pipe plugs on the side of the unit.

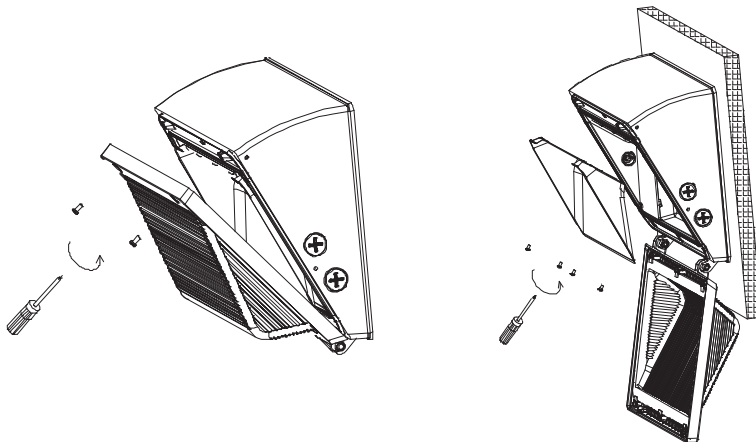

Important: Read all instructions prior to installation.

LED Wall Pack with Glass Lens

Wall/Junction Box Installation

1. Mount rear mounting bracket to surface.
 2. With supply power off, connect wiring.
 3. Slide housing over bracket to hang and secure with set screws at the bottom of the fixture.
- Note: Apply a bead of silicone where the housing meets the mounting surface to avoid potential moisture intrusion.

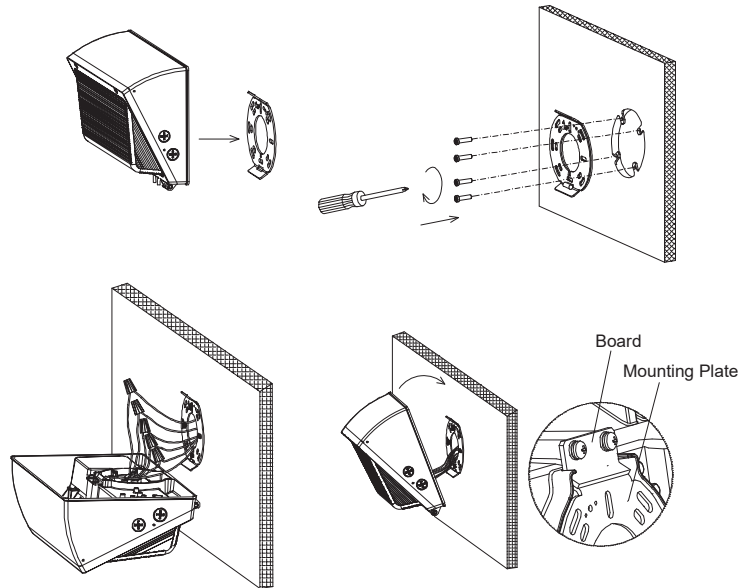

Conduit Installation

1. Mount rear mounting bracket to surface.
 2. Remove screws and remove front cover.
 3. Pull wiring from inside to pull it back through strain relief in rear of housing.
- Note: After pulling wiring through, the hole in the rear housing should be sealed with silicone to prevent water intrusion.
4. Slide housing over bracket to hang and secure with set screws at the bottom of the fixture.
- Note: Apply a bead of silicone where the housing meets the mounting surface to avoid potential moisture intrusion.
5. Remove plug for conduit/wiring.
 6. With supply power off, connect wiring.

