

Dimensional Diagram

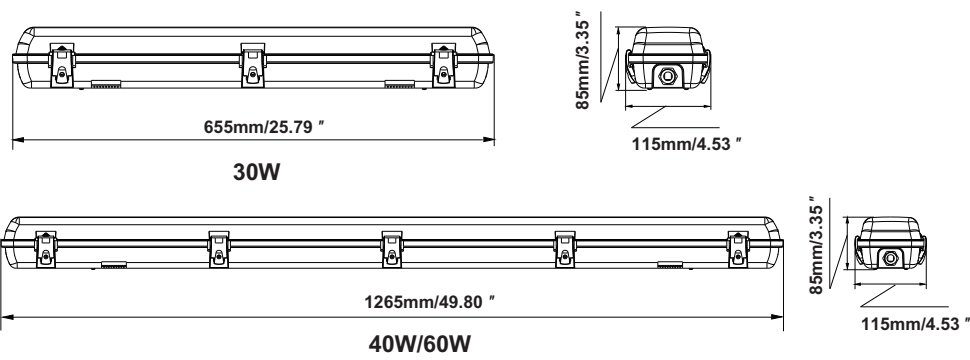

Surface Mount Installation

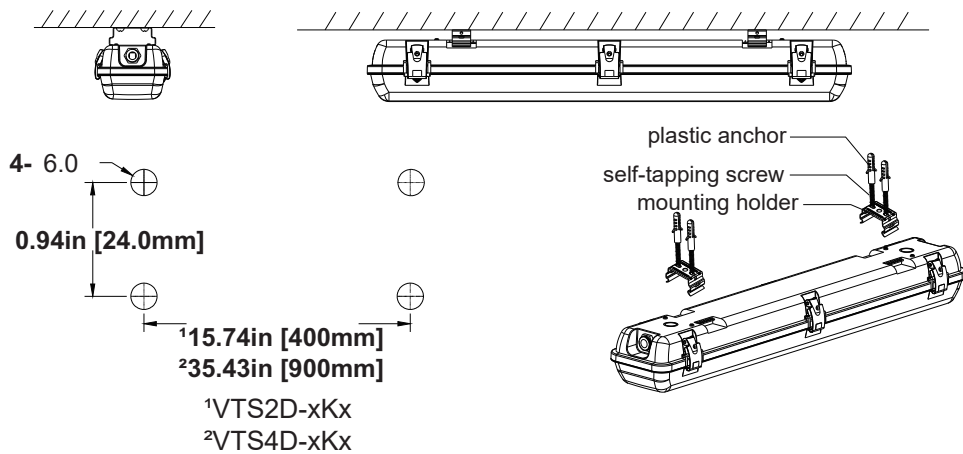

Suspension Installation

Suspension Kit (VTLM-HKO) sold separately at superbrightleds.com

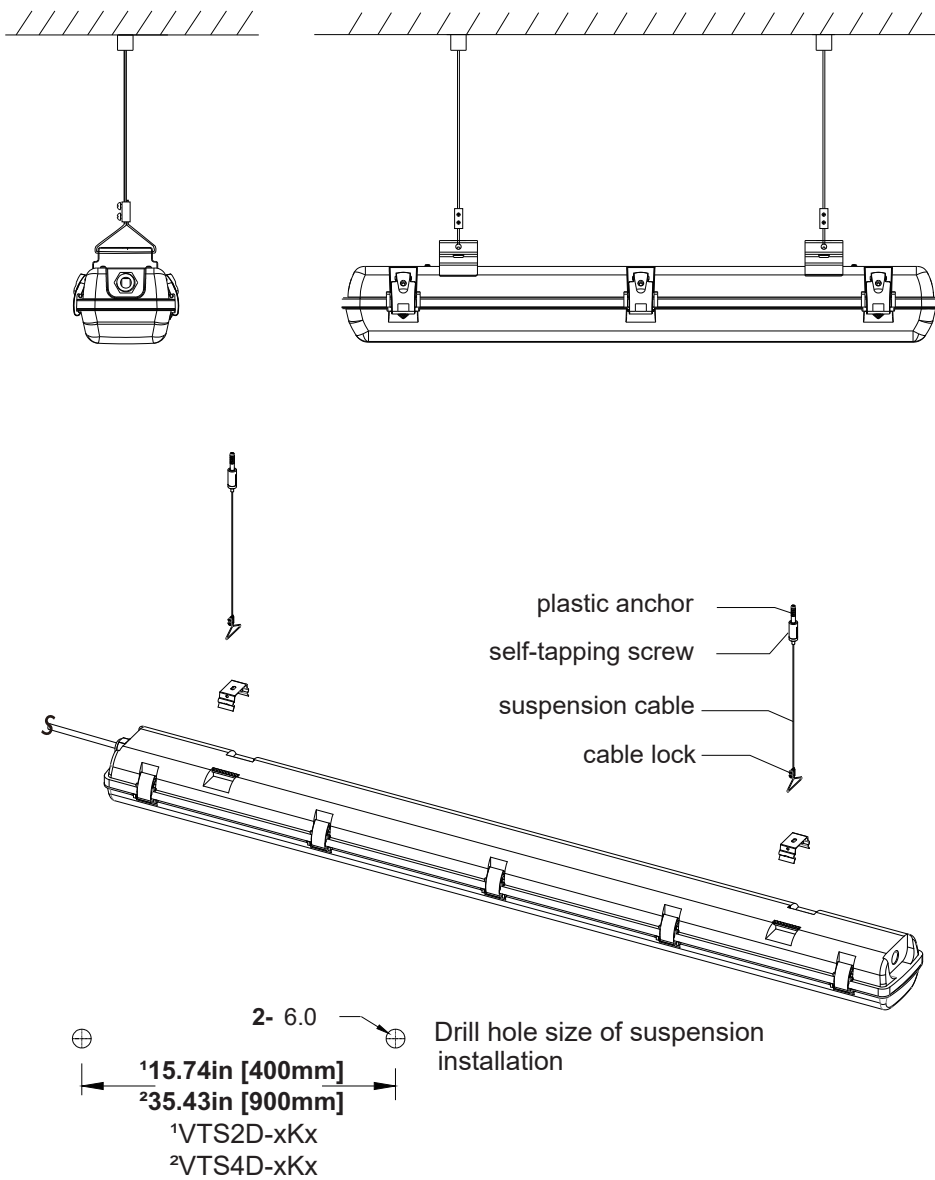

superbrightleds.com

Vapor Tight LED Light Fixture

VTSxD Series

User Manual



Included Parts

- 1 - Vapor Tight LED Light Fixture (VTS2D-xKx or VTS4D-xKx)
- 2 - Mounting Brackets
- 2 - Drywall Anchors
- 2 - M4x 30mm long anchor screws
- 2 - M4 Flat washers
- 2 - Liquid Tight Cord Grip (one loose and one preinstalled in fixture)

Optional Recommended Parts

Available at superbrightleds.com

- Power Cord (_POWERCORD)
- Suspension Kit (VTLM-HKO)
- SJT Cable - Black Jacketed 18 Gauge (WP18-35J)
- 22-12 AWG Orange/Blue 3M Wire Nut (WN-OB2212)
- Motion Sensor Kit (VTS-SENSORKIT)
Note: Requires additional wiring [not included]

Safety and Notes

- This product should be installed by a certified electrician in accordance with applicable national, state, and local building and electrical codes.
 - To reduce the risk of electric shock, ensure that the main power source and circuit breakers are switched off before performing any installation or wiring procedures.
 - Avoid looking directly into the lamp when illuminated.
 - Ensure all mounts are securely attached and will support the weight of the fixture.
- Failure to properly support the fixture may result in damage or injury, for which the manufacturer does not assume responsibility.

Daisy Chain Installation

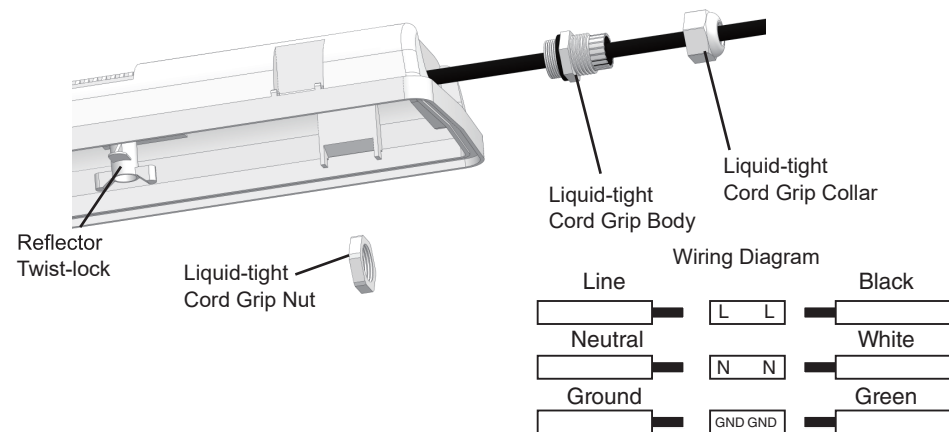

Motion Sensor Installation

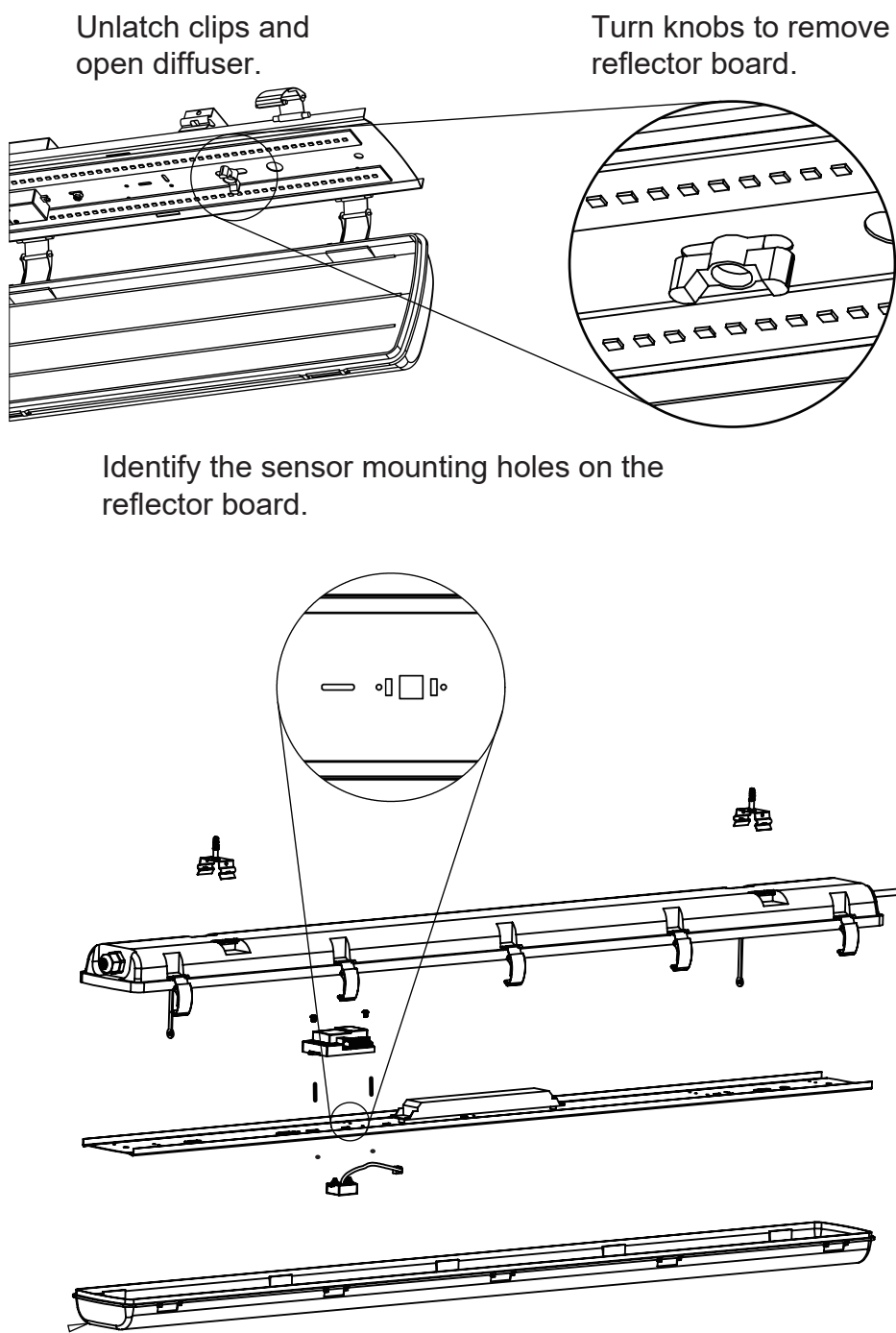

Motion Sensor Installation (continued)

Install mounting hardware, controller, and sensor onto the board using provided hardware. Standoffs can be attached to controller first for easier installation.

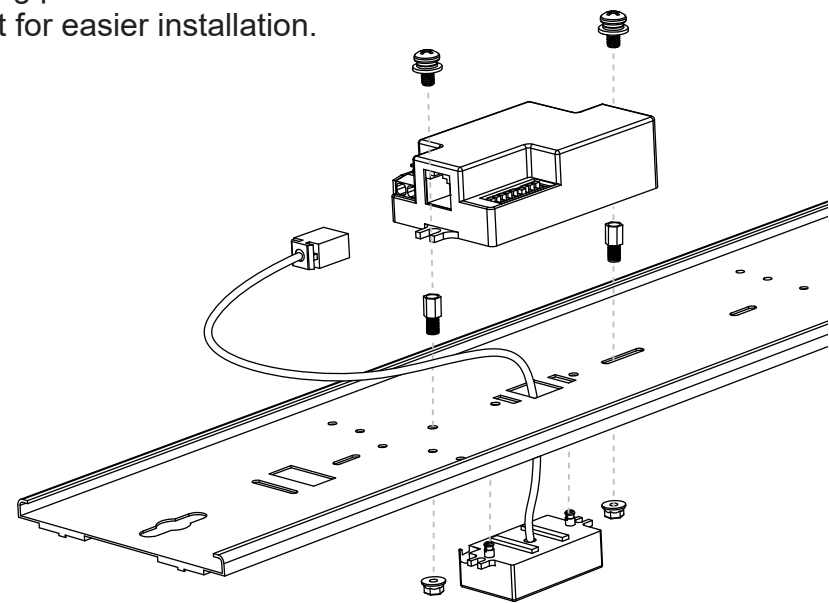

FINAL ASSEMBLY

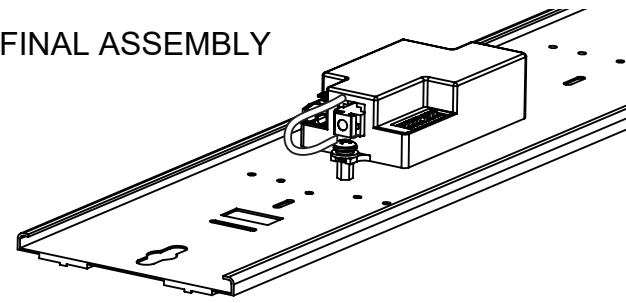

Wire with included instructions (VTS-SENSORKIT). Wire fixture in accordance with national, state, local and electrical codes.

