

Linear Light Series

Industrial Linear LED Light Fixture

Project Name _____

Date _____

Type _____

Industrial LED Light

Linear LED lights are the heavy-duty, super-bright alternatives to traditional tube light fixtures. Perfect for commercial lighting, warehouse lighting, garage lighting, shop lighting, parking garage lighting, and more, the low-bay LED lights have powerful LEDs and high lumen outputs. These durable, weatherproof LED light fixtures consume much less energy than metal-halide (MH) fixtures. And with a life expectancy of 50,000 hours, the linear LED lights reduce costly repairs, disposal fees, and the need for replacements.

Specifications

TPLF-NW2-30	
Intensity	3400 lumen
Operating Voltage Range	100-277 VAC
Beam Angle	180 degree
LED Type	2835 SMD
Number of LEDs	180 LEDs
Color Temperature	5000K
CRI	84 CRI
Operating Temperature	-4 ~ 113°F (-20 ~ 45 °C)
Total Power Consumption	31.5 Watts
IP Rating	IP65
Warranty	5 year
IK Rating	10

TPLF-NW4-50	
Intensity	5500 lumen
Operating Voltage Range	100-277 VAC
Beam Angle	180 degree
LED Type	2835 SMD
Number of LEDs	288 LEDs
Color Temperature	5000K
CRI	86 CRI
Operating Temperature	-4 ~ 113°F (-20 ~ 45 °C)
Total Power Consumption	55 Watts
IP Rating	IP65
Warranty	5 year
IK Rating	10



Assembly Instructions

TP-HKO

1	LED Tri-Proof Light
2	M4 x 8mm Screw
3	M4 Flat Washers
4	Mounting Bracket
5	Hanging Wire Nut
6	Hanging Wire
7	Griplock Screw
8	M4 x 30mm Phillips Screw
9	Hanging Wire Mount
10	Plastic Anchor
11	M3.5 x 40mm Locking Screw

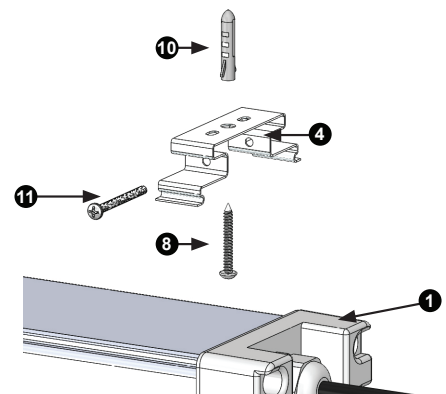
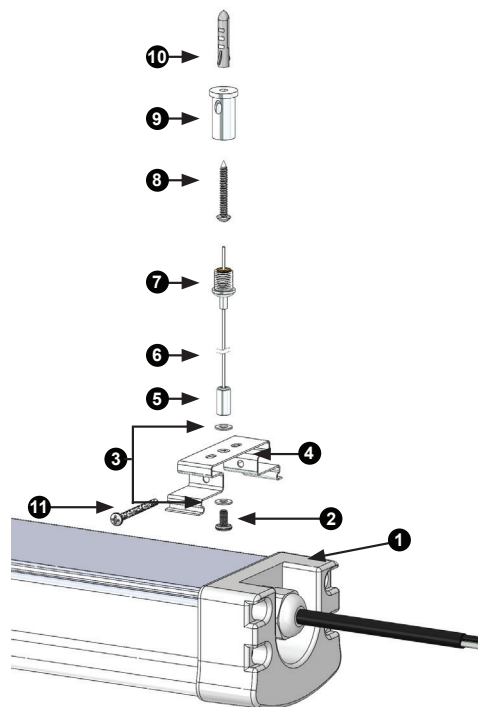

1. Hanging Installation

Tighten the screw with screwdriver

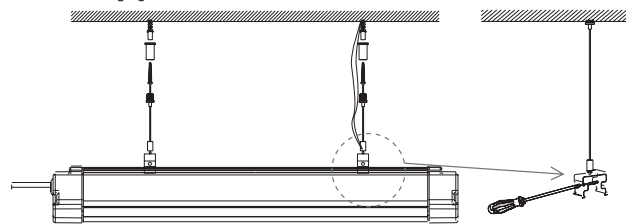

Conventional UL/VDE standard wire for 18AWG / 3 x0.75mm²

Ordering Information

LED Product	Color Temperature / Length	Watt
TPLF - Tri-Proof Linear Fixture	NW4 - 4700K Natural White, 4ft NW2 - 4700K Natural White, 2ft	30 - watts 50 - watts

Lumens
2700 lumen 5500 lumen

Mounting Options
TP-HKO - Hanging Kit



Rev Date: V1.1 06/08/2017

US: <https://www.superbrightleds.com/cat/led-linear-lighting/>

commercial-sales@superbrightleds.com

T 314.743.3067
F 314.972.6202



Dimensional Drawing

TPLF-NW2-30

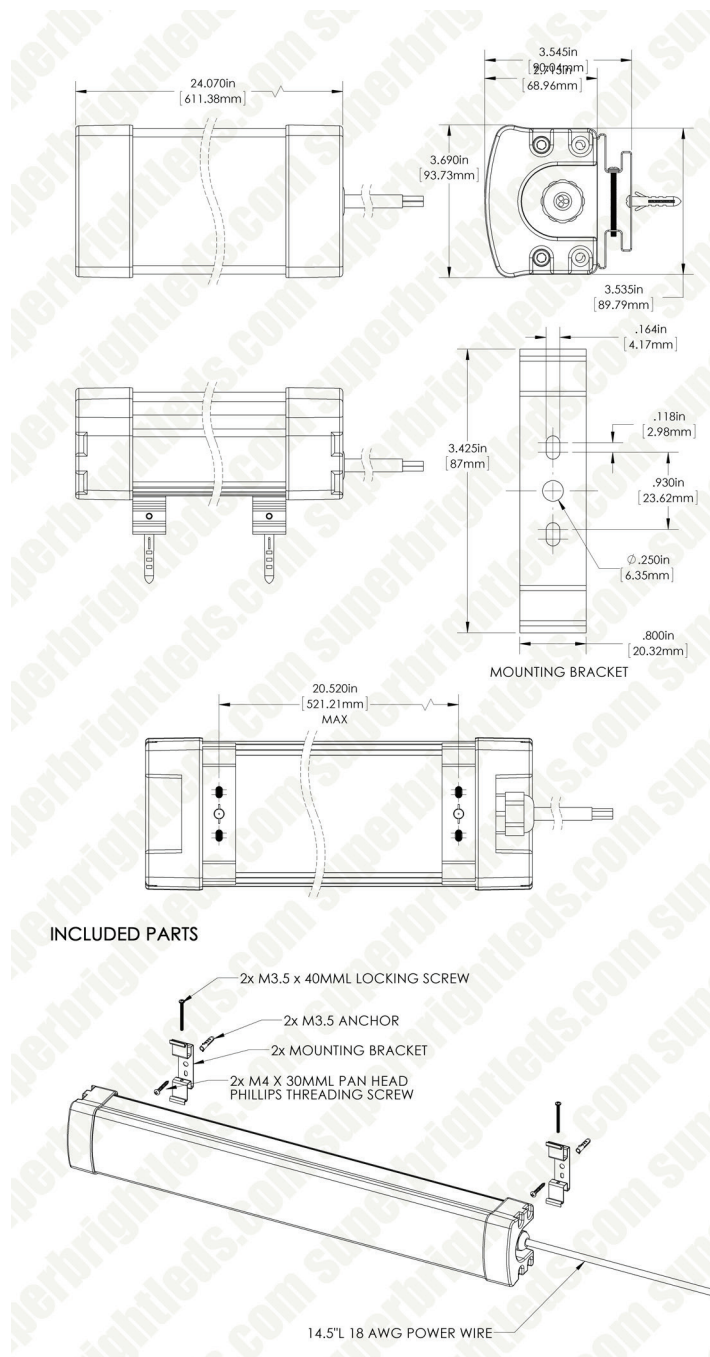

TPLF-NW4-50

