

Important: Read all instructions prior to installation.

T8 LED Tube

Type A + B can use both Type A Installation or Type B installation. Luminaire can be installed either way depending on application.

Installation (Type A)

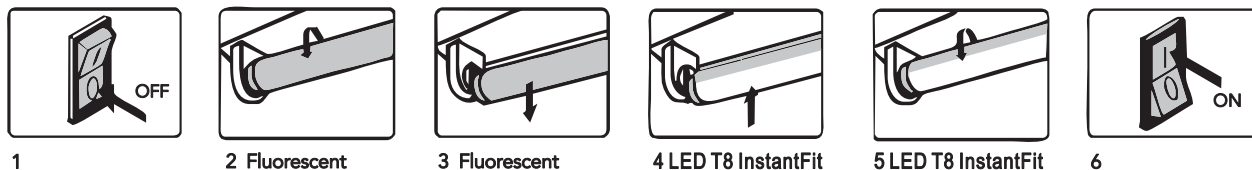

1. Turn off the power.
2. Remove diffuser (if provided).
3. Remove the fluorescent tubes. Please dispose of these items properly as they contain mercury.
4. Put LED tube in lighting fixture.
5. Install the LED tubes, close diffuser (if provided).
6. Turn on the power.

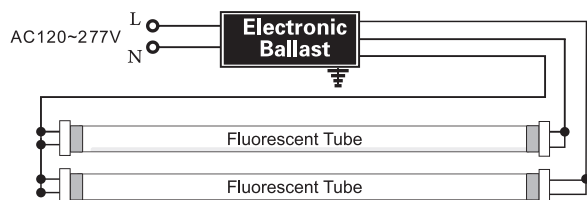

Before

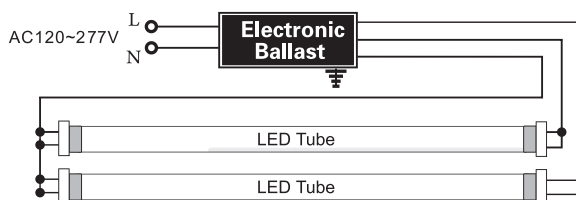

After

(UL TypeA)

Retrofit Procedure (Type B)

1. Turn off the power.
2. Remove diffuser (if provided).
3. Remove the fluorescent tubes. Please dispose of these items properly as they contain mercury.
4. Cut the wires as shown in the diagram.
5. Make the new wire connect to branch circuit as shown.
6. Replace the cover over the wiring channel.
7. Install the LED tubes, close the diffuser.
8. Turn on the power.

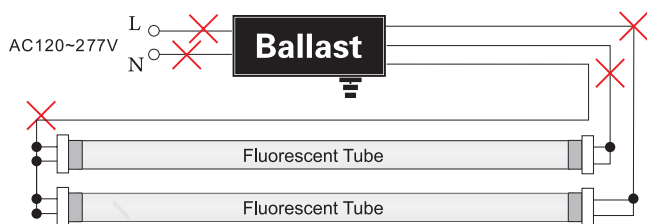

Before

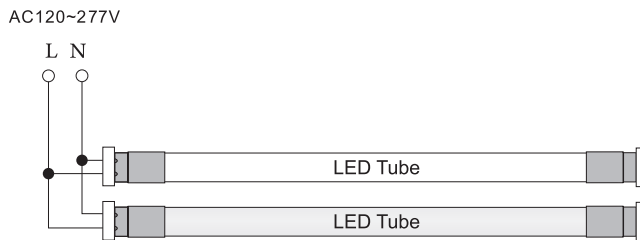

After

(UL TypeB)

Warning

1. These lamps should be installed by a licensed electrician.
2. These lamps should be used indoors (damp or dry locations only). Not suitable for wet locations.
3. Make sure tombstones/lampholder are still in good condition and are not defective before installation.
4. Ensure the brand and model number of the ballast is in the compatible ballast list for your product.
5. Make sure the ballast is working before installation.
6. This device is not suitable for emergency exits.
7. These lamps are not suitable to be used with a dimmer.

