

Important: Read all instructions prior to installation.

4ft LED Linkable Shop Light

Linking Fixtures Together

Repeat installation steps for additional lights. Use interconnects to make power connections from one light to the next. Connections are made from socket "F" of the first light to socket "M" of the next light. The interconnects are also marked "F" and "M" and must be installed "F" to "F" and "M" to "M" when making connections. A maximum of 10 fixtures can be linked.

Notes

- Only connect to adjacent light fixtures.
- Pull chain does not switch power to additional fixtures.
- Link up to 10 fixtures together.
- Assume that the fixture is mounted onto a structurally sound ceiling that will support the fixture.
- The fixture is designed for use in 120VAC, 60Hz fused circuit. Do not use on a dimming circuit.
- Use hooks to support chain, not the electrical cord.
- Do not install on radiant-heating type ceiling.

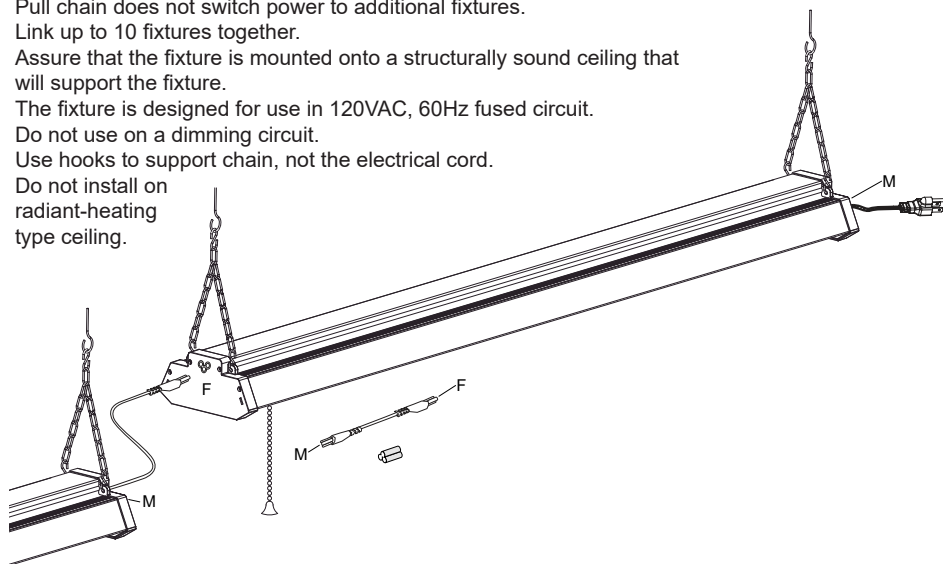

4ft LED Linkable Shop Light

SLLP-NW4-42

Installation Manual



SLLP-I25, SLLP-I142

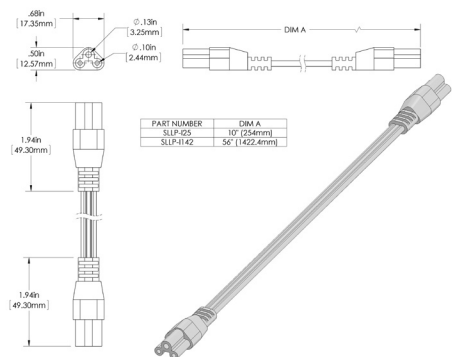

SLLP-DC

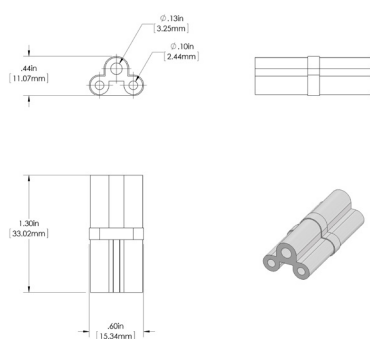

Important: Read all instructions prior to installation.

4ft LED Linkable Shop Light

Included Parts

- 1 - 4' LED Shop Light
- 4 - 12" Chain
- 8 - "S" Hook
- 2 - Ceiling Hook
- 1 - Power Cord
- 1 - Direct Interconnect (SLLP-DC)
- 1 - 56" Interconnect (SLLP-I142)

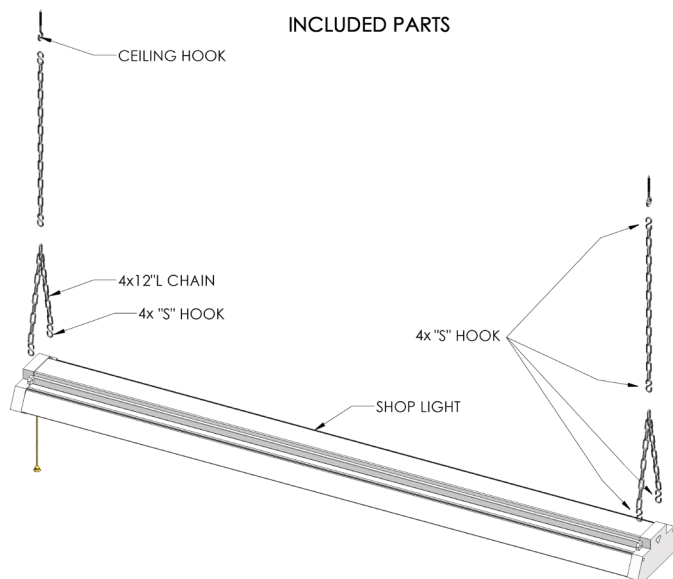

Recommended Accessories (sold separately)

- 10" Interconnect (SLLP-I25)

Specifications

SLLP-NW4-42	
Intensity	4500 lumen
Total Power Consumption	40 Watts
Current Draw @ 120VAC	365 mA
Color Temperature	5000K
Beam Angle	150°
CRI	82
Dimmable	No
Connection Type	3 Prong Grounded Plug
IP Rating	IP20
LED Quantity	120 pcs
Operating Voltage Range	120 VAC
Operating Temperature	-4 ~ 104°F (-20 ~ 40 °C)
Fixture Weight	5.2lbs (2.3 Kg)
Warranty	5 Year

NOTE: A maximum of 10 fixtures can be linked.

FCC Statement

This device complies with part 15 of the FCC Rules. Operation is subject to the following two conditions: (1) This device may not cause harmful interference, and (2) This device must accept any interference received, including interference that may cause undesired operation. Any changes or modifications in construction of this device which are not expressly approved by the party responsible for compliance could void the user's authority to operate the equipment.

Installation Instructions For Single Light

Attach Ceiling Hooks

- Choose desired location of light fixture. For an unfinished ceiling, use a pencil to mark where each ceiling hook should go. Drill 1/16th pilot holes and screw hooks approximately 4ft apart.
- For finished ceiling, use drywall anchors or toggle bolts (not included), or locate joists and install as in step 1 above.

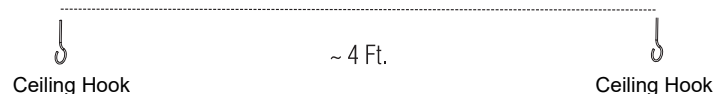

Attach "S" Hooks

- Insert "S" hooks into holes on both ends of shop light. (FIG. 1)

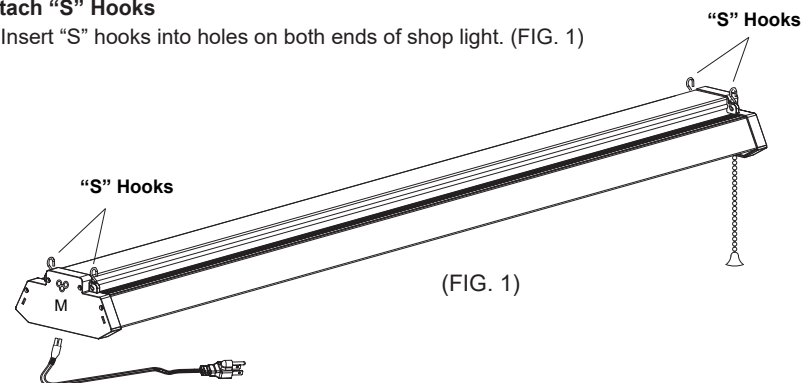

Attach Hanging Chain

- Assemble hanging chains as show in FIG. 2 below.
- Crimp all "S" hooks closed (FIG. 3)
- Remove power socket cover labeled "M" and plug in powercord.
- Plug power cord into outlet. Use pull chain to power on.

