

superbrightleds.com

Recessed Dimmable LED Light Fixture with Junction Box

RLF4D-xW10-JB

RLF6D-xW10-JB

RLF6D-xW15-JB

RLF8D-xW35-JB

User Manual



Important: Read all instructions prior to installation.

Recessed Dimmable LED Light Fixture

RLF4D-xW10-JB
 RLF6D-xW10-JB
 RLF6D-xW15-JB
 RLF8D-xW35-JB

Specifications

RLF4D-xW10-JB		RLF6D-xW10-JB	
Operating Voltage	120 VAC	Operating Voltage	120 VAC
Beam Angle	90 degree	Beam Angle	90 degree
Operating Temperature	-22~122°F (-30~50 °C)	Operating Temperature	-22~122°F (-30~50 °C)
Total Power Consumption	10 Watts	Total Power Consumption	10 Watts
IP Rating	IP44	IP Rating	IP44
Fixture Weight	12 oz (340g)	Fixture Weight	1 lb (453g)
Warranty	5 Years	Warranty	5 Years

RLF6D-xW15-JB		RLF8D-xW35-JB	
Operating Voltage	120 VAC	Operating Voltage	120 VAC
Beam Angle	90 degree	Beam Angle	90 degree
Operating Temperature	-22~122°F (-30~50 °C)	Operating Temperature	-22~122°F (-30~50 °C)
Total Power Consumption	15 Watts	Total Power Consumption	35 Watts
IP Rating	IP44	IP Rating	IP44
Fixture Weight	1 lb (453g)	Fixture Weight	2 lb 11oz (1219g)
Warranty	5 Years	Warranty	5 Years

Safety and Notes

- Product should be installed by a certified electrician in accordance with applicable national, state, and local building and electrical codes.
- To reduce the risk of electric shock, ensure that main power source and circuit breakers are switched off before performing any installation or wiring procedures.
- Avoid looking directly into lamp when illuminated.
- Ensure all mounts are securely attached and will support weight of the fixture. Failure to properly support the fixture may result in damage or injury, for which the manufacturer does not assume responsibility.
- Suitable for use in enclosures.
- For indoor use only. Suitable for installation in damp locations. Avoid direct contact with water and other liquids.
- Clean with a soft damp cloth only, do not use any chemical cleaners.

Installation Instructions

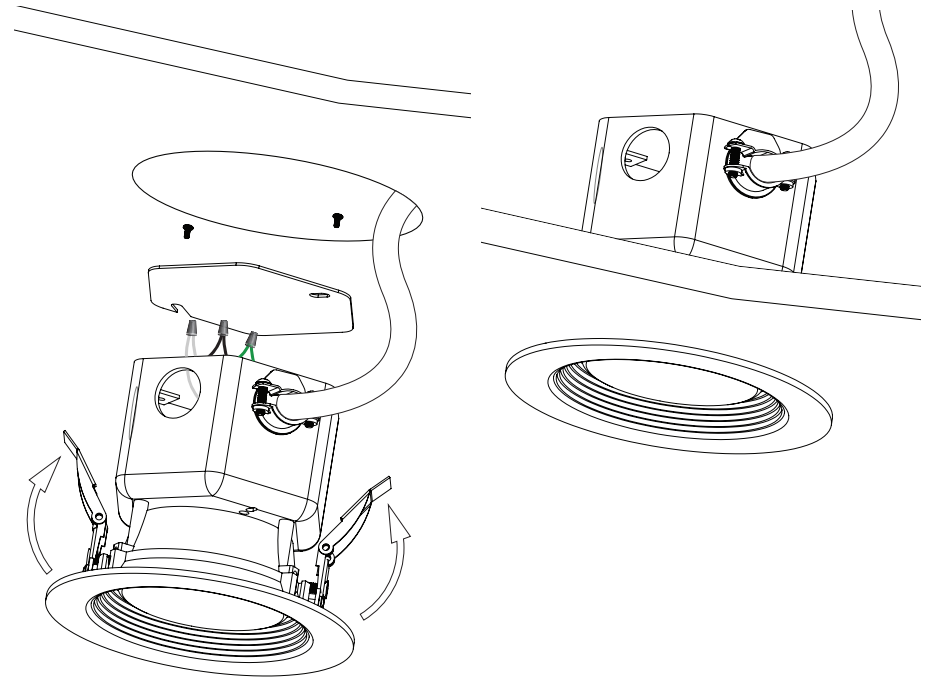

1. Shut off power before installation. Cut a corresponding hole in the ceiling. A template is provided to assist with laying out hole location. When running the supply wires, allow an additional 18" of wire at each fixture in order to make electrical connections on room side of hole.
2. Remove junction box cover. Install supply wire(s) through knockout hole on junction box according to local codes. Connect wires black to black, white to white, and green to green. Make sure all connections are secure, tuck all wires inside junction box and reinstall junction box cover.
3. Press top portion of spring clips against side of housing assembly.
4. Push fixture and spring clips through the hole until spring clips snap into place and the trim is tight against the ceiling surface.