

**superbrightleds.com**

Recessed Dimmable LED Light Fixture  
with Junction Box

RLF4D-xW10-JB

RLF6D-xW10-JB

RLF6D-xW15-JB

RLF8D-xW35-JB

Installation Manual



Important: Read all instructions prior to installation.

**Recessed Dimmable LED Light Fixture**

**Specifications**

RLF4D-xW10-JB		RLF6D-xW10-JB	
Operating Voltage	120 VAC	Operating Voltage	120 VAC
Beam Angle	90 degree	Beam Angle	90 degree
LED Type / Quantity	2835 / 20	LED Type / Quantity	2835 / 20
Intensity (NW, WW)	650 / 570 lumen	Intensity (NW, WW)	650 / 570 lumen
Color Temperature	4000K / 3000K	Color Temperature	4000K / 3000K
CRI	93	CRI	93
Operating Temperature	-22~122°F (-30~50 °C)	Operating Temperature	-22~122°F (-30~50 °C)
Total Power Consumption	10 Watts	Total Power Consumption	10 Watts
IP Rating	IP44	IP Rating	IP44
Fixture Weight	12 oz (340g)	Fixture Weight	1 lb (453g)
Warranty	5 Years	Warranty	5 Years

RLF6D-xW15-JB		RLF8D-xW35-JB	
Operating Voltage	120 VAC	Operating Voltage	120 VAC
Beam Angle	90 degree	Beam Angle	90 degree
LED Type / Quantity	2835 / 30	LED Type / Quantity	2835 / 66
Intensity (NW, WW)	960 / 880 lumen	Intensity (NW, WW)	2800 / 2600 lumen
Color Temperature	4000K / 3000K	Color Temperature	4000K / 3000K
CRI	93	CRI	93
Operating Temperature	-22~122°F (-30~50 °C)	Operating Temperature	-22~122°F (-30~50 °C)
Total Power Consumption	15 Watts	Total Power Consumption	35 Watts
IP Rating	IP44	IP Rating	IP44
Fixture Weight	1 lb (453g)	Fixture Weight	2 lb 11oz (1219g)
Warranty	5 Years	Warranty	5 Years

\* Only dimmable at 120 VAC

**Safety and Notes**

- SUITABLE FOR DAMP LOCATIONS
- SUITABLE FOR TYPE IC OR FOR TYPE NON-IC.
- To avoid possible electrical shock, be sure that power supply is turned off at fuse box or circuit breaker before installing or servicing fixture.
- For indoor use only, avoid direct contact with water and other liquids.
- Clean with a soft damp cloth only, do not use any chemical cleaners.
- Before installation of any recessed lighting luminaire check your local electrical code. This code sets the wiring standards for your locality and should be carefully studied before starting.
- The luminaire light can be dimmed with a standard triac dimmer. Electronic low voltage (ELV) recommended.

**Installation Instructions**

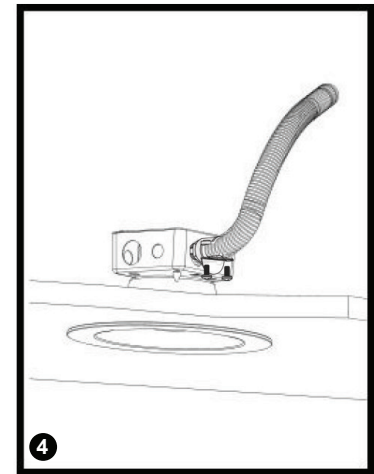
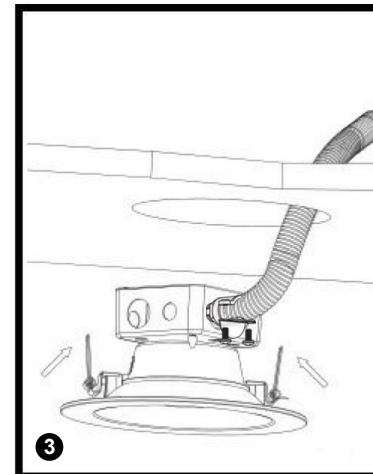
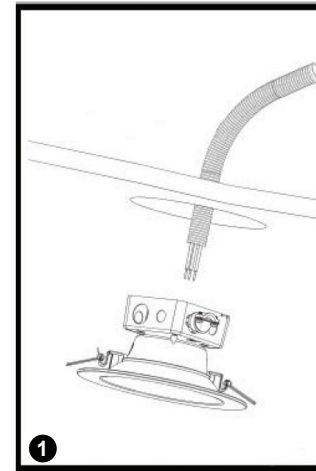

1. Shut off power before installation. Cut a corresponding hole in the ceiling. A template is provided to assist with laying out hole location. When running the supply wires, allow an additional 18" of wire at each fixture in order to make electrical connections on room side of hole.
2. Remove junction box cover. Install supply wire(s) through knockout hole on junction box according to local codes. Connect wires black to black, white to white, and green to green. Make sure all connections are secure, tuck all wires inside junction box and reinstall junction box cover.
3. Press top portion of spring clips against side of housing assembly.
4. Push fixture and spring clips through the hole until spring clips snap into place and the trim is tight against the ceiling surface.