

PRODUCT DESCRIPTION

The PIKO extrusion is useful in interior design, furniture, exhibitions.



Closet Rated

- Super small - only 10mm wide (0.39")
- Narrow line of light

FINISH :

Silver anodized



Fill empty fields

Product nr.	
Fixture type	
Company	
Job name	
Date	

TECHNICAL SPECIFICATION

Application

- The extrusion is designed for use in gaps of various materials with small cross-sections. It can be mounted to the edge of thin planes, glass, plastics etc. used in the furniture, exhibition, etc.

Assembly

- designed to be mounted to the surface with screws or two-sided adhesive tape.

Additional information

- the extrusion is suitable for bending into gentle curves, in the plane adjacent to the LED strip
- the extrusion comes with frosted covers (diffusers) and aluminum-colored plastic end caps

Extrusion bending

Minimum internal radius
150 mm / 5.9"

Minimum external radius
150 mm / 5.9"

- Minimum radius - bending radius which when exceeded causes destruction (deformation, bending or lack of compatibility with other accessories, e.g. covers, end caps, etc.) of the profile.
- Internal radius - refers to the extrusion bent so that the cover is facing the inside of the arch.
- External radius - refers to the extrusion bent so that the cover is facing the outside of the arch.
- Irregular curves are possible after consultation and individual quotation.
- When bending anodized extrusions, one should be aware of cracking of the anode coating (which may be more or less visible depending on the radius).

Turn off LED lights during peak day light hours in outdoor applications to avoid excessive heat buildup which will result in diminished LED life.

TECHNICAL DRAWING

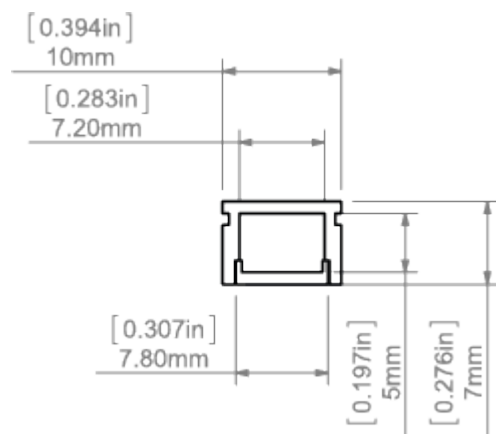

RELATED PRODUCTS

COVERS



PIKO Cover
Ref: 17034

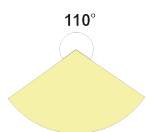

END CAPS

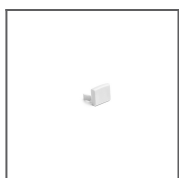

PIKO End cap
Ref: 24202

ACCESSORIES



8,8x1,2 Gland
Ref: 00802

LED TAPES

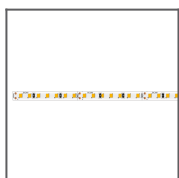

LED strip
K-40-1091-24V
2.8W/F
Ref:
K-40-1091-24V

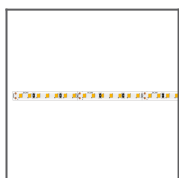

LED strip
K-30-1091-24V
2.8W/F
Ref:
K-30-1091-24V

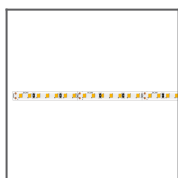

LED strip
K-22-1091-24V
2.8W/F
Ref:
K-22-1091-24V

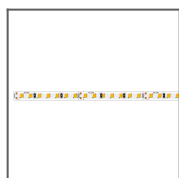

LED strip
K-25-1091-24V
2.8W/F
Ref:
K-25-1091-24V

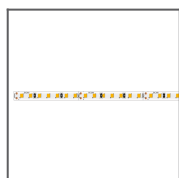

LED strip
K-27-1091-24V
2.8W/F
Ref:
K-27-1091-24V

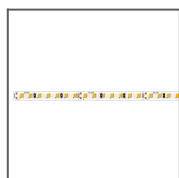

LED strip
K-35-1091-24V
2.8W/F
Ref:
K-35-1091-24V

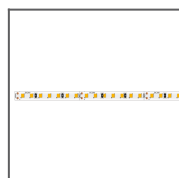

LED strip
K-50-1091-24V
2.8W/F
Ref:
K-50-1091-24V