

PRODUCT DESCRIPTION

Architectural extrusions for LED tape – dedicated to be mounted into ceilings and drywall.

Patent Number: US D724,259S



Closet Rated

- Ability to create a line of light
- Easy mounting using various techniques
- Can be combined in straight and broken linear runs
- Designed to reach an IP65 waterproof rating

FINISH :

Silver anodized ☐

RAL ☒ ☐

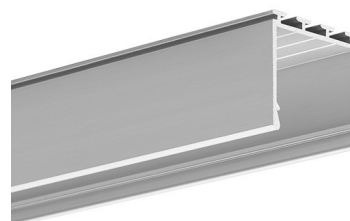

Fill empty fields

Product nr.	
Fixture type	
Company	
Job name	
Date	

TECHNICAL SPECIFICATION

Application

- surface mounted or suspended lighting fixtures

Assembly

- using surface springs
- using suspension accessories
- using mounting adhesive

Additional information

- ability to construct polygonal fixtures using ZM connectors

Architectural extrusions for LED tape – dedicated to be mounted into ceilings and drywall. The height of the extrusion was designed to produce a single line of light with LEDs spaced 15 mm (0.59") apart and a frosted cover HS 22. The extrusion can accommodate two of the 10 mm (0.39") wide LED strips. Extrusion can be mounted to a surface with the use of mounting springs.

Extrusion bending

Minimum internal radius
3000 mm / 118.1"

Minimum external radius
3000 mm / 118.1"

- Minimum radius – bending radius which when exceeded causes destruction (deformation, bending or lack of compatibility with other accessories, e.g. covers, end caps, etc.) of the profile.
- Internal radius – refers to the extrusion bent so that the cover is facing the inside of the arch.
- External radius – refers to the extrusion bent so that the cover is facing the outside of the arch.
- Irregular curves are possible after consultation and individual quotation.
- When bending anodized extrusions, one should be aware of cracking of the anode coating (which may be more or less visible depending on the radius).

Possibility of making a linear fixture with IP64 protection, which means the fixture is dustproof and waterproof. Achieving IP64 is possible with the following covers: LIGER-22, MUN-22 and HS-22.

Turn off LED lights during peak day light hours in outdoor applications to avoid excessive heat buildup which will result in diminished LED life.

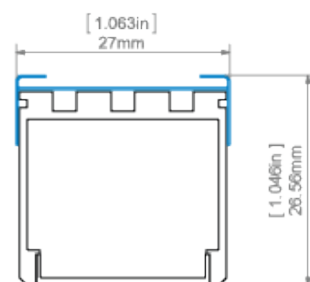
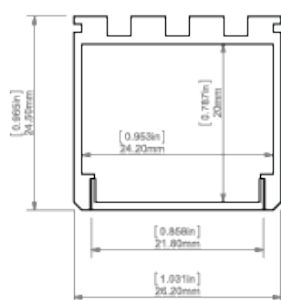
TECHNICAL DRAWING

LIPOD extrusion and AM-24 mounting bracket

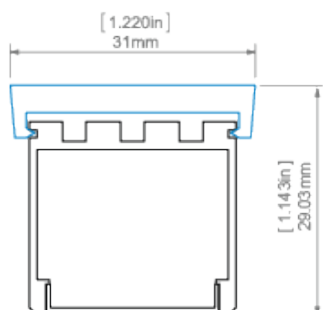

LIPOD extrusion GIP mounting bracket

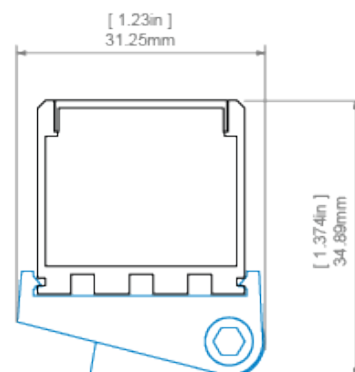

LIPOD extrusion and REGIP-UV mounting bracket

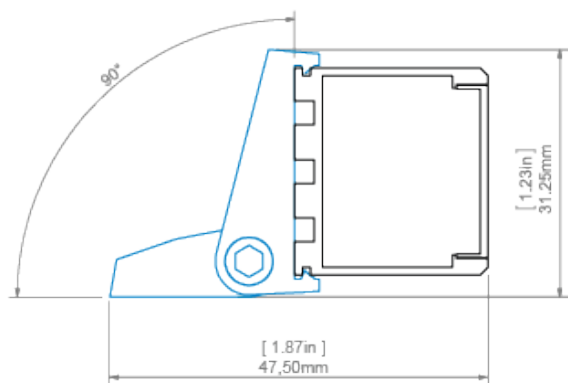

LIPOD extrusion and REGIP-UV mounting bracket

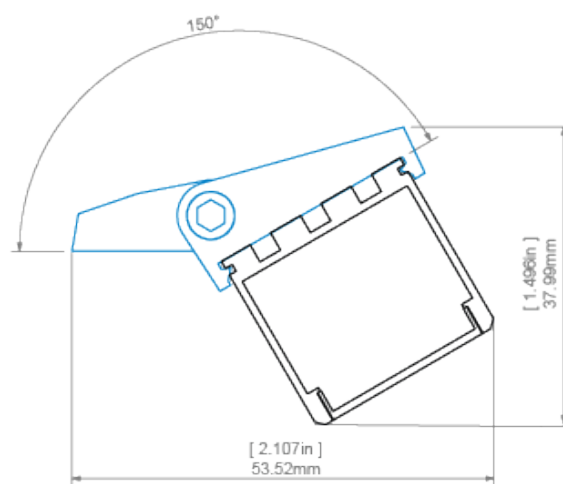

LIPOD extrusion and REGIP-UV mounting bracket

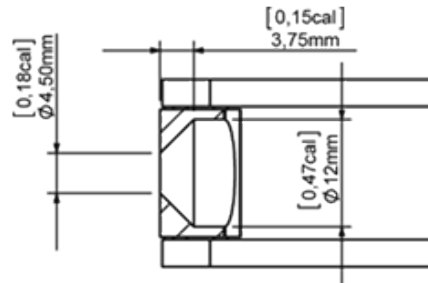
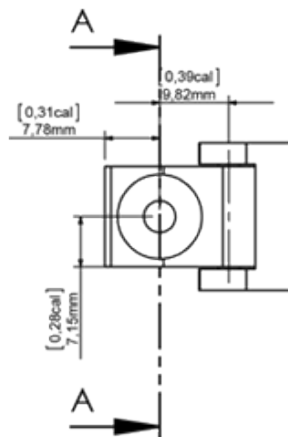

SECTION A-A

RELATED EXTRUSIONS

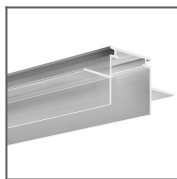

TEKNIK Extrusion
Ref: B5555V1NA

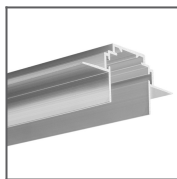

TEKNIK-ZM
Extrusion
Ref: C0399NA

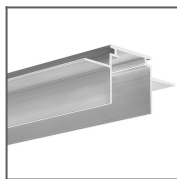

TEKUS Extrusion
Ref: B6638V1NA

RELATED PRODUCTS

COVERS

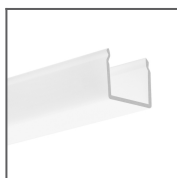

G-K Cover
frosted
Ref: 17007

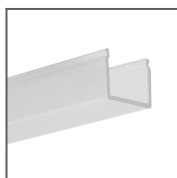

G-K Cover semi-
transparent
Ref: 00415

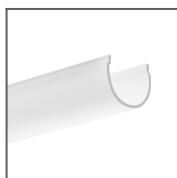

G-L Cover
frosted
Ref: 00413

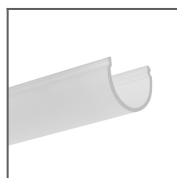

G-L Cover semi-
transparent
Ref: 17008

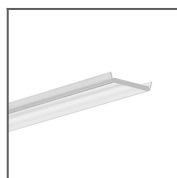

HS-22 Cover
clear
Ref: 17022

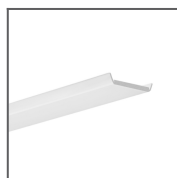

HS-22 Cover
frosted
Ref: 17011

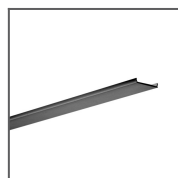

LIGER-22 Cover
black
Ref: 17044

70°



100°



80°

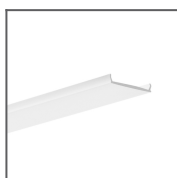

LIGER-22 Cover
frosted
Ref: 17032

110°



END CAPS



LIPOD End cap
Ref: 24004

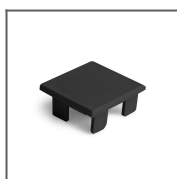

LIPOD End cap
Ref: 24263

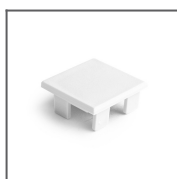

LIPOD End cap
Ref: 24283



LIPOD-MET End
cap
Ref: 24051

ACCESSORIES

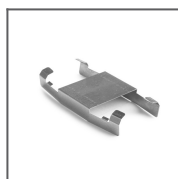

AM-24 Mounting
bracket
Ref: 24235



GIP Mounting
bracket
Ref: 24143



REGIP-UV
Adjustable
Mounting
bracket
Ref: 24271



PUSZ-LIN-ZM
Fastener
Ref: 42256



PUSZ-PRET-ZM
Fastener
Ref: 42250

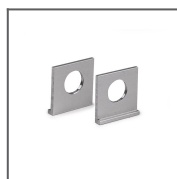

UCHO-ZM
Hanger
Ref: 42512



TEKNIK Clip
Ref: 24003



BZP Head
Ref: 42213



BZP-ZZ Head
conductive
Ref: 42215

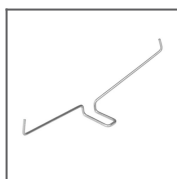

GP Spring
Ref: 00293



DP-ZZ Fastener
Ref: 00651

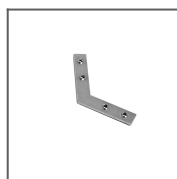

ZM-120
Connector
Ref: 42728

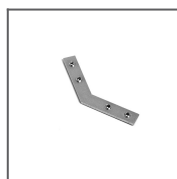

ZM-135
Connector
Ref: 42720

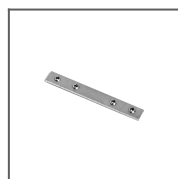

ZM-180
Connector
Ref: 42717

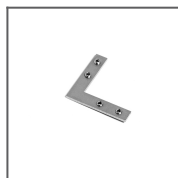

ZM-90 Connector
Ref: 42716

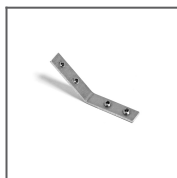

ZM-PION-135
Connector
Ref: 42719

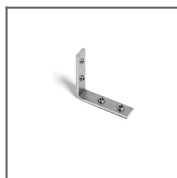

ZM-PION-90
Connector
Ref: 42718

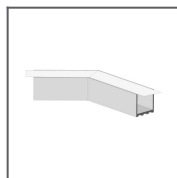

L135 Coupler
Ref: _

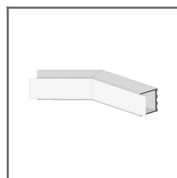

L135PW Coupler
Ref: _

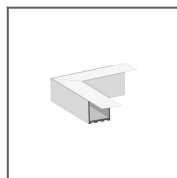

L90 Coupler
Ref: _

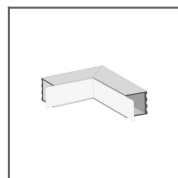

L90PW Coupler
Ref: _

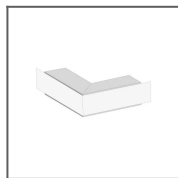

L90PZ Coupler
Ref: _

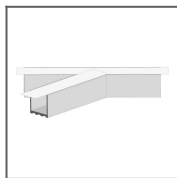

T135L Coupler
Ref: _

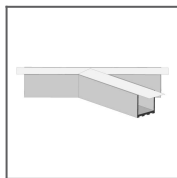

T135R Coupler
Ref: _



T90 Coupler
Ref: _

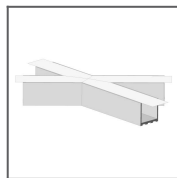

X135 Coupler
Ref: _

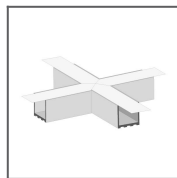

X90 Coupler
Ref: _



Isolating bases
0,1" / 3mm
Ref: 42205



Isolating bases
0,2" / 5mm
Ref: 42204



Isolating bases
0,2" / 6mm
Ref: 42203

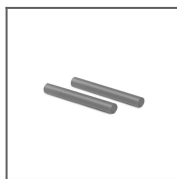

ZM Block
Ref: 42520

LED TAPES

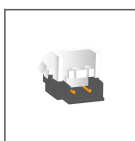

C-SC-IP20
Ref: C-SC-IP20

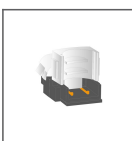

C-SC-IP65
Ref: C-SC-IP65

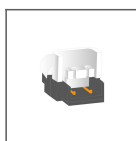

C-SS-IP20
Ref: C-SS-IP20



C-SS-IP65
Ref: C-SS-IP65

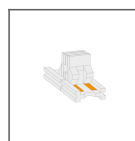

C1-0W
Ref: C1-0W

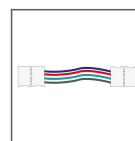

C11-RGB-1.5W
Ref: C11-RGB-1.5W

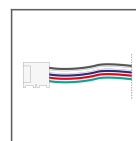

C14-RGB+W-6W
Ref: C14-
RGB+W-6W

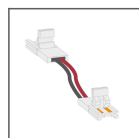
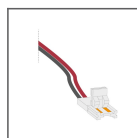
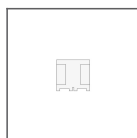
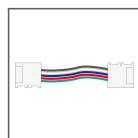
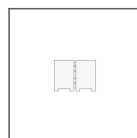
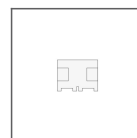
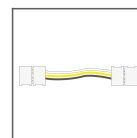
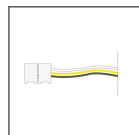
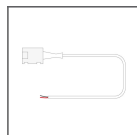
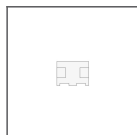
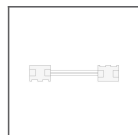

C2-1.5W
Ref: C2-1.5W

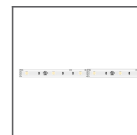
C3-6W
Ref: C3-6W

C4-RGB+W-0W
Ref: C4-RGB+W-0W

C5-RGB+W-1.5W
Ref: C5-RGB+W-1.5W

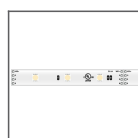
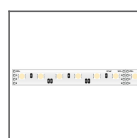
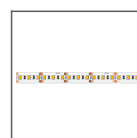
C6-RGB-0W
Ref: C6-RGB-0W

C7-AW-0W
Ref: C7-AW-0W

C8-AW-1.5W
Ref: C8-AW-1.5W

C9-AW-6W
Ref: C9-AW-6W

HD-C4-6W
Ref: HD-C4-6W

HD-C5-0W
Ref: HD-C5-0W

HD-C6-1.5W
Ref: HD-C6-1.5W

K-1210-12V
Ref: K-1210-12

K-1210-24V
Ref: K-1210-24

K-1215-RGB-12V
Ref: K-1215-
RGB-12V

K-1215-RGB-24V
Ref: K-1215-RGB-24V

K-1220-12V
Ref: K-1220-12

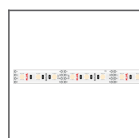
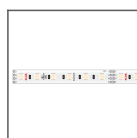
K-1220-24V
Ref: K-1220-24

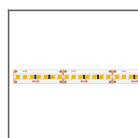
K-1225-RGB-12V
Ref: K-1225-RGB-12V

K-1225-RGB-24V
Ref: K-1225-RGB-24V

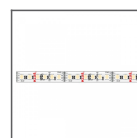
K-1275-12V
Ref: K-1275-12

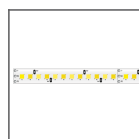
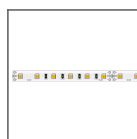
K-1275-24V
Ref: K-1275-24

K-1275-RGB-12V
Ref: K-1275-RGB-12V

K-1275-RGB-24V
Ref: K-1275-RGB-24V

K-1530-RGB+W-24V
Ref: K-1530-
RGB+W-24V

K-1820-HD-24V
Ref: K-1820-HD-24

K-1910-HD-24V
Ref: K-1910-HD-24

K-1920-120-RGB-24V
Ref: K-1920-120-
RGB-24V

K-1920-RGB+W-24V
Ref: K-1920-
RGB+W-24V

K-22/50-1728-24V
Ref: K-22/50-1728-24V

K-27/65-1920-24V
Ref: K-2765-1920-24V

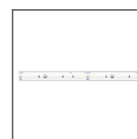
K-30/18-1770-24V
Ref: K-30/18-1770-24V

K-LR-1000-24V
Ref: K-LR-1000-24

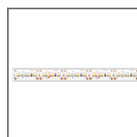
WP-K-1210-12V
Ref: WP-K-1210-12

WP-K-1210-24V
Ref: WP-K-1210-24

WP-K-1215-RGB-12V
Ref: WP-K-1215-
RGB-12V

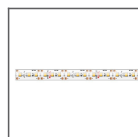
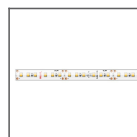
WP-K-1215-RGB-24V
Ref: WP-K-1215-
RGB-24

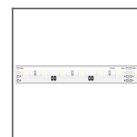
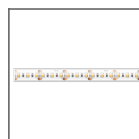
WP-K-1220-12V
Ref: WP-K-1220-12

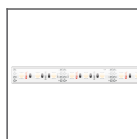
WP-K-1220-24V
Ref: WP-K-1220-24

WP-K-1220-IP65-12V
Ref: WP-K-1220-
IP65-12V

WP-K-1220-IP65-24V
Ref: WP-K-1220-
IP65-24V

WP-K-1225-RGB-12V
Ref: WP-K-1225-
RGB-12V

WP-K-1225-RGB-24V
Ref: WP-K-1225-
RGB-24V

WP-K-1275-12V
Ref: WP-K-1275-12

WP-K-1275-24V
Ref: WP-K-1275-24

WP-K-1275-RGB-12V
Ref: WP-K-1275-
RGB-12V

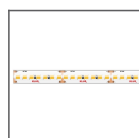
WP-K-1275-RGB-24V
Ref: WP-K-1275-
RGB-24V

WP-K-1530-RGB+W-24V
Ref: WP-K-1530-
RGB+W-24V

WP-K-1640-HD-IP65-24
Ref: WP-K-1640-HD-
IP65-24

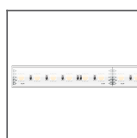
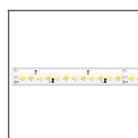
WP-K-1820-HD-24
Ref: WP-K-1820-
HD-24

WP-K-1910-HD-IP65-24
Ref: WP-K-1910-HD-
IP65-24

WP-K-1920-120-RGB-24V
Ref: WP-K-1920-120-
RGB-24V

WP-K-1920-RGB+W-24V
Ref: WP-K-1920-
RGB+W-24V

WP-K-22/50-1728-24V
Ref: WP-
K-22/50-1728-24V

WP-K-27/65-1920-24V
Ref: WP-
K-2765-1920-24V

WP-K-30/18-1770-24V
Ref: WP-
K-30/18-1770-24V