

Important: Read all instructions prior to installation.

LED Low Voltage Landscape Light

Parts Included

- A - Lamp Head
- B - Center Tube
- C - Ground Stake
- (D,E,F) - Threaded Connector
- AA - Adapter Trays

Preparation Instructions

Before beginning assembly, installation or operation of product, make sure all parts are present. Compare parts with package contents list and diagram on previous page. If any part is missing or damaged, do not attempt to assemble, install or operate the product. Contact customer service for replacement parts.

Estimated Assembly Time: 15 minutes. Helpful tools: Trowel/Shovel.

Assembly Instructions

1. Install the lamp head (A) to the threaded center tube (B).
2. Install the ground stake (C) to the threaded center tube (B).
3. To install, loosen the ground with a trowel/shovel (not included) and/or soften the soil with water, then press the fixture into the ground. Do not use a hammer. Do not exert excessive force on the fixture while installing as this may cause the fixture to break.
4. Remove the quick connector cap (D) from the quick connector base (F). Set the connector block (E) aside.

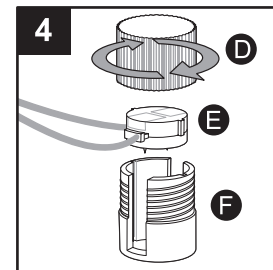
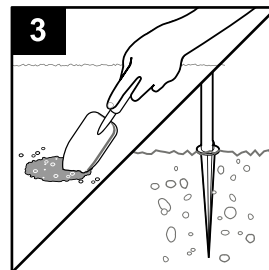
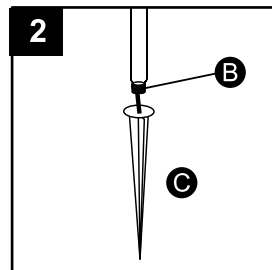
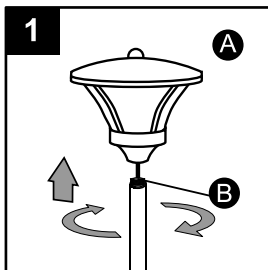

5. Four (4) adapter trays (AA) are included. Each is marked accordingly: 12 AWG, 14 AWG, 16 AWG and 18 AWG. Select the adapter tray (AA) that matches the gauge of the power cable (not included).
6. Place the power cable on the adapter tray (AA). Align with the grooves in the quick connector base (F) followed by the connector block (E). NOTE: To ensure uniform brightness, the first fixture should be a minimum of 10 ft. (3m) from the power pack/transformer (not included).
7. Install the quick connector cap (D) onto the quick connector base (F). Screw the quick connector cap (D) until it is secure, making sure not to overtighten.

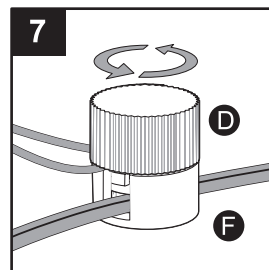
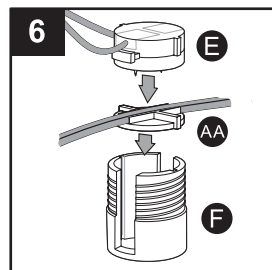
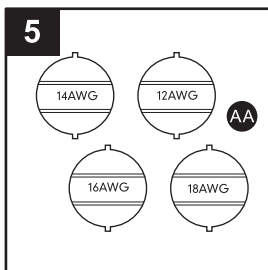

Care and Maintenance: To clean, unplug lamp and wipe with a damp, non-abrasive cloth.

Troubleshooting

PROBLEM	POSSIBLE CAUSE	CORRECTION ACTION
LED light will not turn on	<ol style="list-style-type: none">1. No power.2. Loose wire to the connector3. Connector not making contact with primary cable.4. Power pack/transformer's photo cell sensor is exposed to unwanted light source.	<ol style="list-style-type: none">1. Wattage of power pack/transformer may be exceeded.2. Make sure brass contact pins pierce the plastic wire insulation and are touching the copper wires inside.3. Make sure cover is tight. If problem persists, repeat steps 3 to 6 on the instructions.4. Make sure that power pack/transformer's photo cell sensor is not exposed to lights.
LED light flickers	<ol style="list-style-type: none">1. Wattage of power pack/transformer may be exceeded.	<ol style="list-style-type: none">1. Check manufacturer's specification for maximum wattage.

Warranty

The manufacturer warrants all of its products against defects in materials and workmanship for three (3) years from the date of purchase. If within this period the product is found to be defective in material or workmanship, please contact the manufacturer, a copy of the original sales receipt will be required as proof of purchase. The manufacturer will, at its option, repair or replace the product. This warranty does not cover products becoming defective due to misuse, accidental damage, improper handling and/or installation and specifically excludes liability for direct, incidental or consequential damages. As some states do not allow exclusions or limitations on an implied warranty, the above exclusions and limitations may not apply to you. This warranty gives you specific legal rights, and you may have other rights that vary from state to state.

Warning

- Risk of fire or electrical shock. Read all of these instructions thoroughly before use. Keep this instruction manual in a safe place for future reference.
- Do not install or connect wires with wet hands.
- Do not install this product within 10 ft. from a pool, spa, fountain, or other body of water.
- The fixture wire and primary cables are intended for shallow burial - maximum depth must not exceed 3 in.
- For low-voltage landscape lighting systems only.
- Do not step on or drive over the branch cable or power cable.

Caution

- This lighting fixture is only suitable for a 12~15volt power supply.
- This LED lamp is a highly efficient, extremely low wattage, energy-saving product. However, it is not recommended to use a power pack/transformer over 100 watts.
- Use shielded cable for outdoor use in the following sizes: 18G, 16G, 14G, 12G.
- Do not submerge in water.
- Do not repair or modify this product.



4400 Earth City Expy, St. Louis MO 63045



866-590-3533



support@superbrightleds.com