

Important: Read all instructions prior to installation.

LED Dimmable Parking Lot Light

Product



Safety and Notes

- This product should be installed by a fully certified electrician in accordance with local building and electrical codes.
- Due to risk of electric shock, ensure that the main power source and circuit breakers are switched off before performing any installation or wiring procedures.
- Failure to properly support the fixture during installation may cause damage or injury, for which the manufacturer is not responsible. Ensure the light bracket/eye bolt is securely mounted and will support the weight of the fixture.

Wiring Diagram

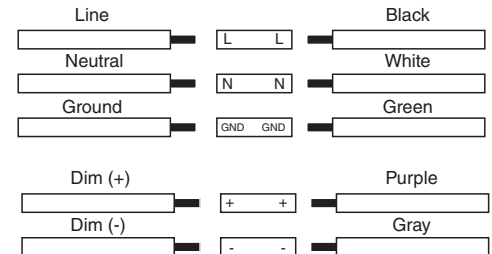

Mounting Options

Knuckle Mount Slip Fitter Kit (PLL-KM)

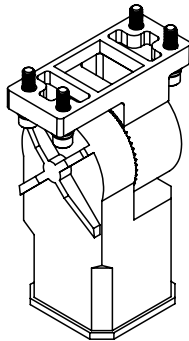

Universal Arm Mount Kit Round/Square Pole (PLL-PM)

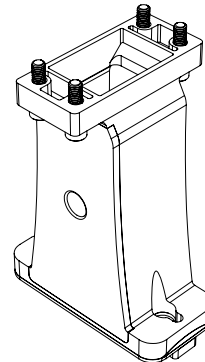

Wall Mount Kit (PLL-WM)

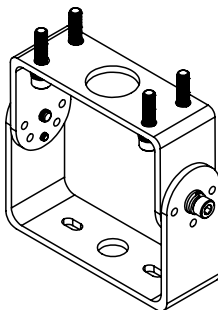

Trunion Mount Kit (PLL-TM)

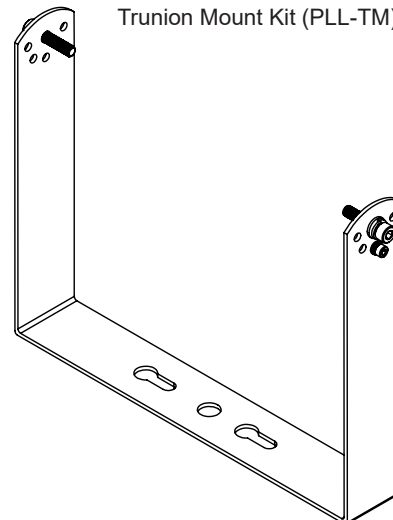

Important: Read all instructions prior to installation.

LED Dimmable Parking Lot Light

Knuckle Mount Slip Fitter Removal and Installation (PLL-KM)

Slip Fitter Removal

1. Remove 2 screws from wire access plate.
2. Loosen socket head cap screw inside wire access cavity with 10mm allen (not included).
3. Remove slip fitter mount to light fixture using (x4) M8x30mm screws with 6mm allen wrench (not included).

Installation

1. Remove power prior to installation.
2. Remove 2 screws from wire access cover plate and feed wires through slip fitter cavity to exit bottom of mount.
3. Attach slip fitter mount to light fixture using (x4) M8x30mm screws with 6mm allen wrench (not included).
4. Connect fixture wire leads to supply wires. (See Wire Diagram)
5. Loosen pole set screws from slip fitter base and slide slip fitter on top of pole.
6. Tighten pole set screws on side of slip fitter to attach to light pole.
7. Adjust angle per application by loosening socket head cap screw inside wire access cavity with 10mm allen (not included).
8. Reinstall wire access cover plate.

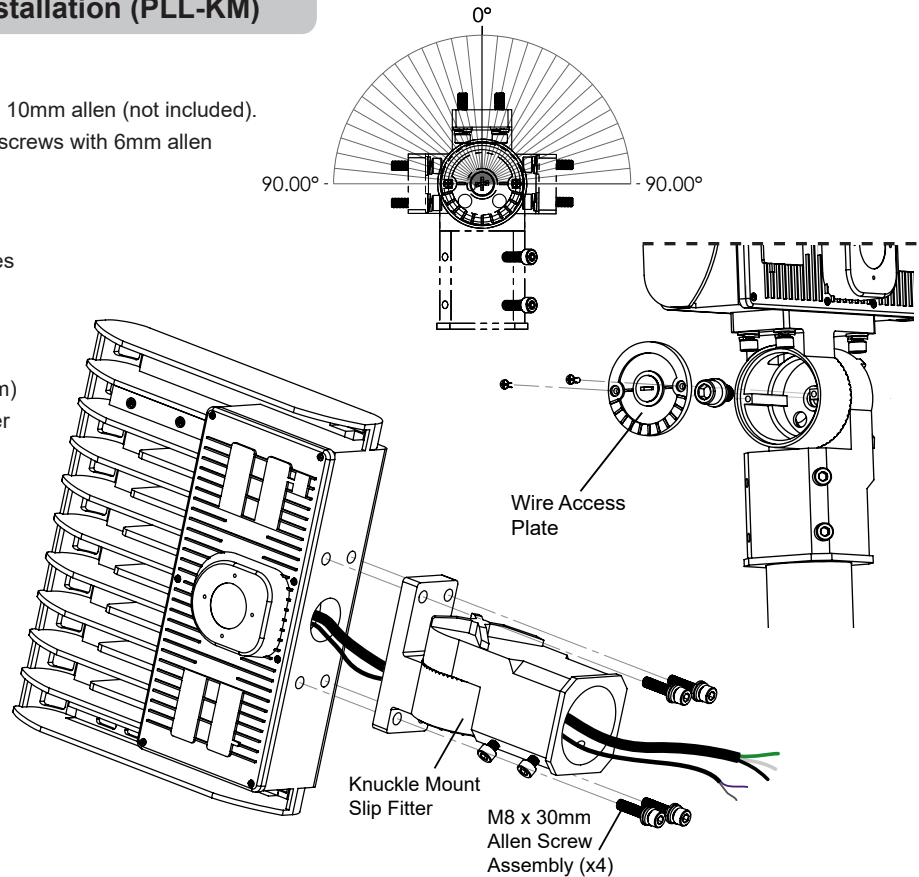

Round/Square Installation (PLL-PM)

1. Remove screw from wire access plate on mount arm and remove plate.
2. Use pole mount plate to mark hole pattern on outside of pole. Drill three mounting holes for M8 mounting screws. Drill one hole for wiring.
3. Place pole mount plate inside pole with corresponding flat or convex mating surface toward pole. Loosely thread two M8 mounting screws into plate—through pole—to hold the plate in place.
4. With the proper gasket (round pole) or gaskets (square pole) in place. Slide the mount arm over the two partially installed screws.
5. Thread the third mounting screw through the mount arm and pole into the mount plate and then tighten all three mount screws.
6. Run wire leads through large hole of pole mount into wire access area.
7. Run light wiring into wire access area and attach light to mount using four M8 screws.
8. Connect wiring and reinstall wire access plate.

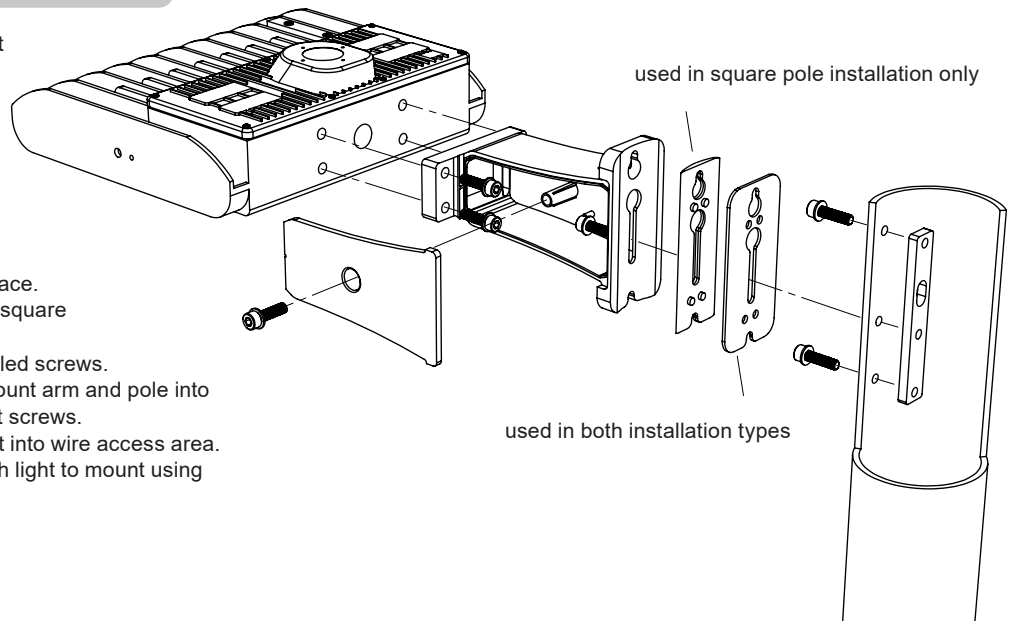

Important: Read all instructions prior to installation.

LED Dimmable Parking Lot Light

Wall Mount Installation (PLL-WM)

1. Install Wall Mount to light fixture.
2. Drill 2 .4375" holes following drill template.
3. Attach fixture to wall mount and adjust angle per application. Secure with M8x30mm long socket head cap screw with 6mm allen (not included).
4. Connect wiring to power supply wires. Black to Line, White to Neutral, and Green to Ground. If 1~10V dimming is used, connect Purple to DIM+ and Gray to DIM-. Consult electrician and install according to national, local, and state codes.
5. Adjust angle using M4x16mm screw (one only provided).

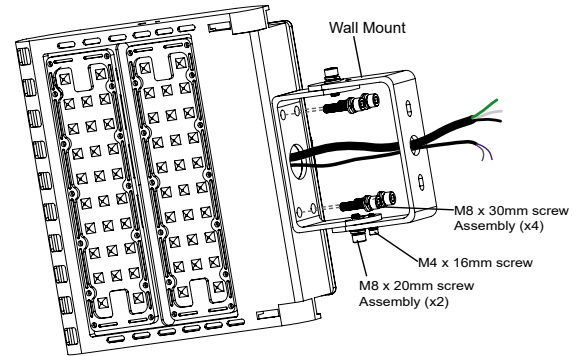

Trunnion Mount Installation

1. Attach Trunnion Mount to fixture using M8 screws and nuts. Secure with allen wrench until lock washer is fully compressed.
2. Drills holes into application using the drill template for proper width.
3. Attach fixture to application using the provided hardware.
4. Connect wiring to power supply wires. Black to Line, White to Neutral, and Green to Ground. If 1~10V dimming is used, connect Purple to DIM+ and Gray to DIM-. Consult electrician and install according to national, local, and state codes.

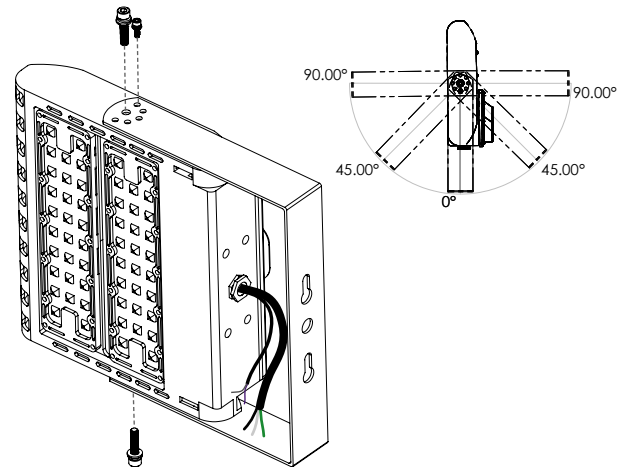

Dimensional Drawings

100W, 150W, 200W PLLD Series

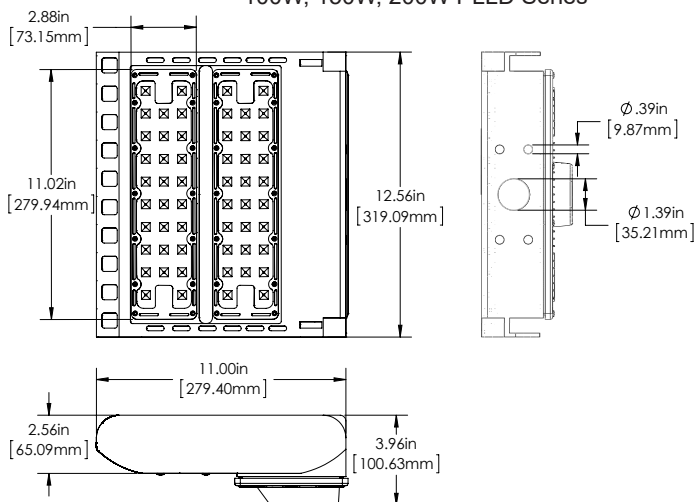

300W PLLD Series

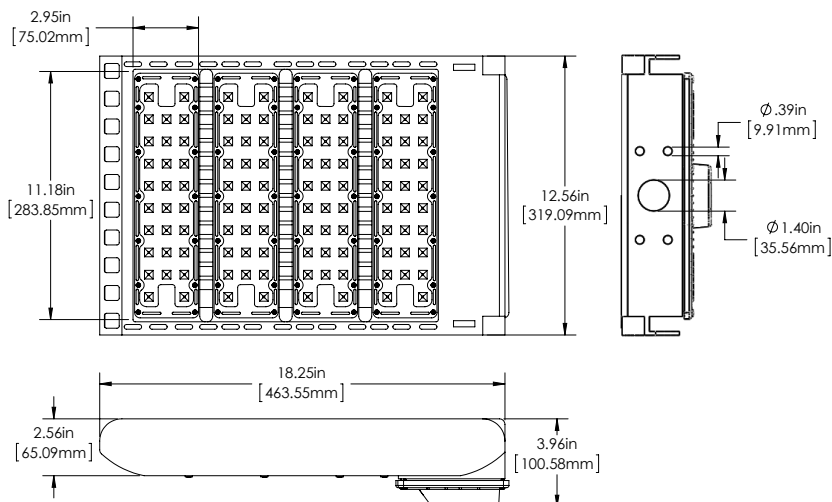

Important: Read all instructions prior to installation.

LED Dimmable Parking Lot Light

Accessory Dimensional Drawings

Knuckle Mount Slip Fitter Kit (PLL-KM)

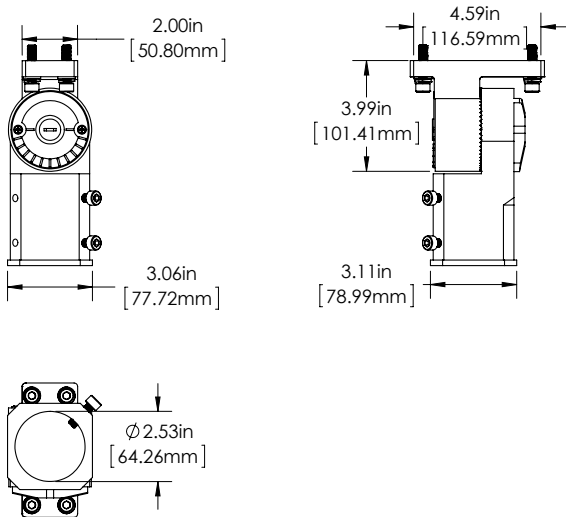

Universal Arm Mount Kit Round/Square Pole (PLL-PM)

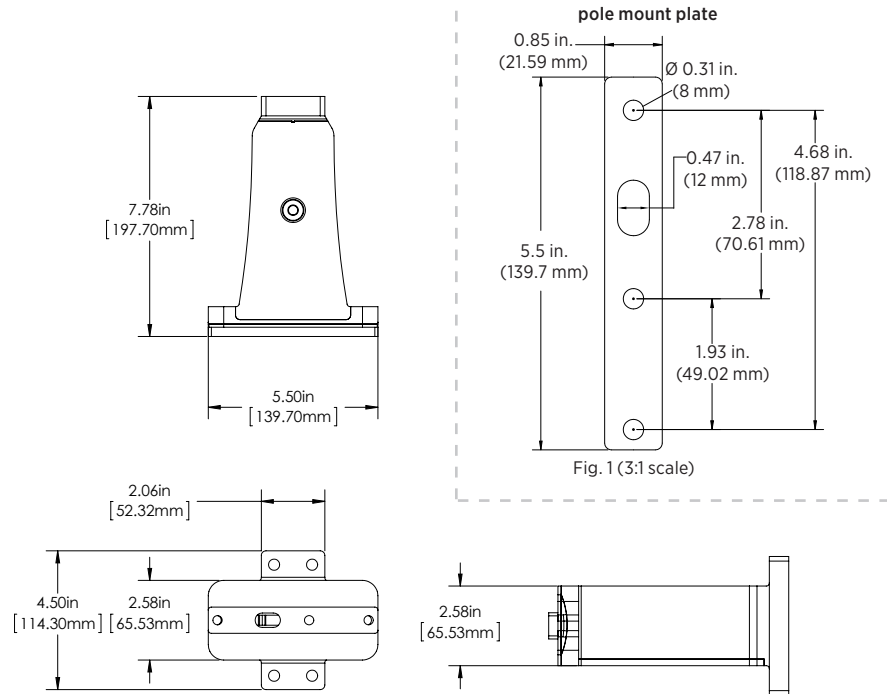
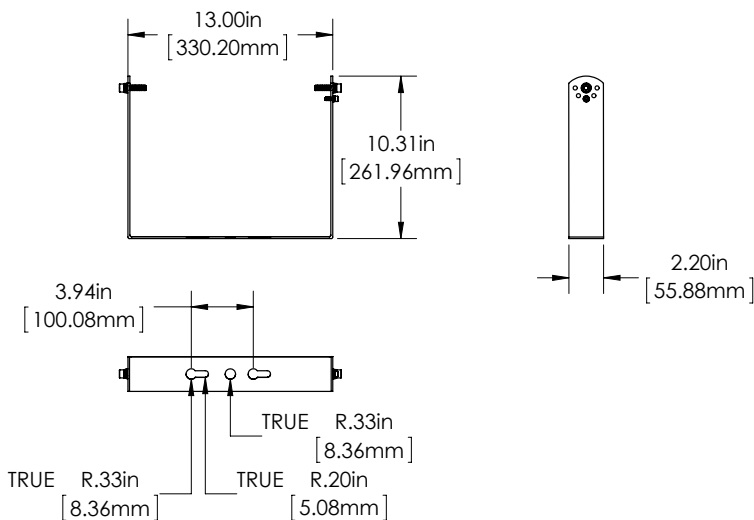

Fig. 1 (3:1 scale)

Universal Arm Mount Kit Square Pole (PLL-SPM)



Trunion Mount Kit (PLL-TM)

