

Mini LED Wall Pack

MWP Series

Wall and Conduit Installation Instructions

1. Remove power from circuit.
2. Remove 2 plastic thumb screws from both sides of the light. Remove mounting bracket from light. Peel adhesive film from Foam Gasket and stick to mounting bracket, while lining up the cut-outs.

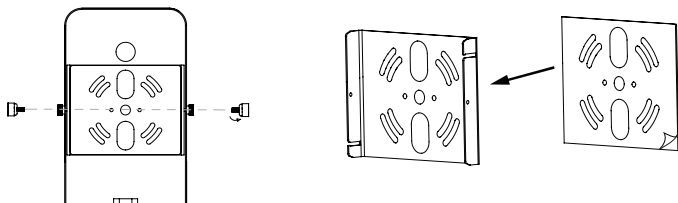

3. Drill 2 holes on the wall using bracket as a guide for holes. Drive wall anchors into holes. Attach mounting bracket to wall using 2 screws (not provided).

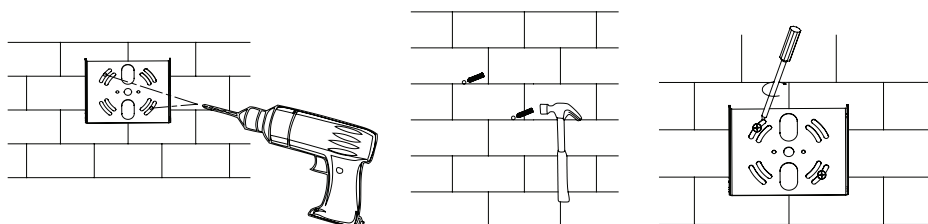

4. Remove knockout from bottom of light. Pull wires from conduit through knockout and make wire connections to main supply. Attach conduit onto light.

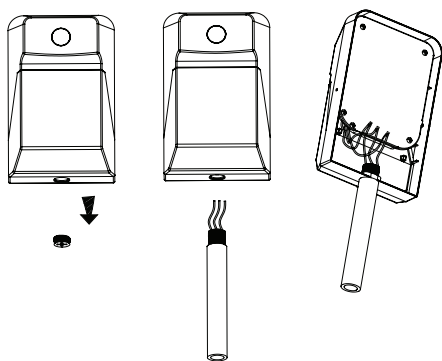

5. Attach light to bracket and tighten 2 plastic thumb screws.

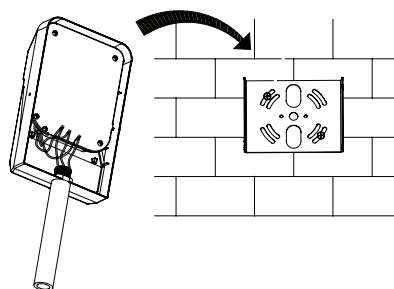

Mini LED Wall Pack

MWP Series



User Manual



Important: Read all instructions prior to installation.

Mini LED Wall Pack

Included Parts

- 1 - Mini LED Wall Pack
- 1 - Foam Gasket

Specifications

MWP-40K20 / MWP-40K20-S / MWP-50K20 / MWP-50K20-S	
IP Rating	IP65
Operating Temperature	-4°–113° F (-20°–45° C)
Weight	1.8 lb (0.8 kg)

Check product label for specific electrical specifications related to installation.
Improper installation will void warranty.

Wire Diagram

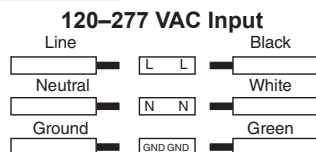

Mounting Bracket Dimensions

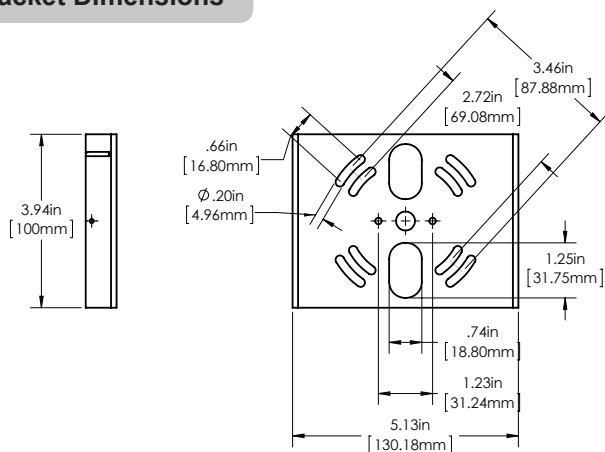

Safety and Notes

- Product should be installed and serviced in accordance with applicable national, state, and local building and electrical codes.
- To reduce the risk of electric shock, ensure that the main power source and circuit breakers are switched off before performing any installation or wiring procedures.
- Avoid looking directly into lamp when illuminated.
- Ensure all mounts are securely attached and will support the weight of the fixture. Failure to properly support fixture may result in damage or injury, for which the manufacturer does not assume responsibility.

Important: Read all instructions prior to installation.

Mini LED Wall Pack

J-Box Installation Instructions

- Remove power from circuit.
- Remove 2 plastic thumb screws from both sides of the light. Remove mounting bracket from light. Peel adhesive film from Foam Gasket and stick to mounting bracket, lining up the cut-outs.

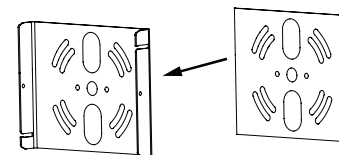
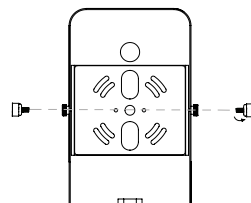

- Mount bracket to J-box with 2 screws (not included). Pull wires from J-box through bracket.

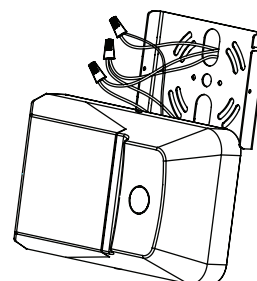
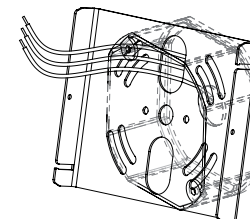

- Use slots to temporarily hang light on mounting bracket to J-box. Make wire connections to main supply. Push connected wires through bracket into J-box.

Note: Wire connections can stay within light.

- Mount light on bracket. Secure with 2 plastic thumb screws on both sides.

