

Important: Read all instructions prior to installation.

Mini LED Wall Pack

Conduit Installation

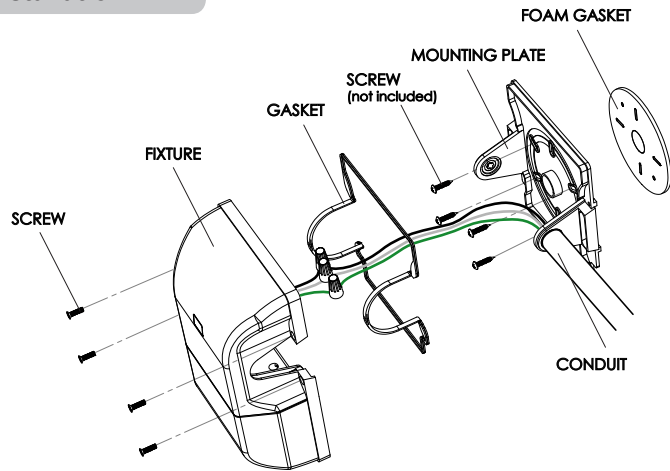

Dimensional Drawings

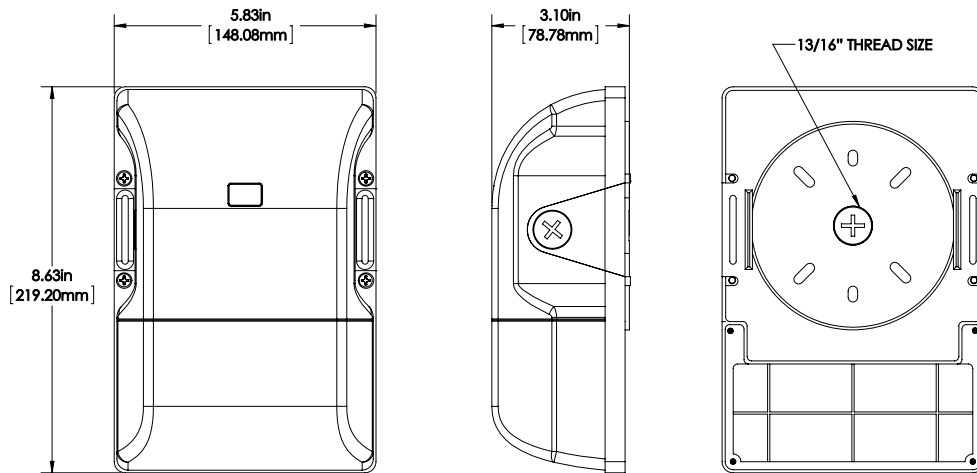

Mini LED Wall Pack

User Manual

MWP2-xKxW-SAFBR Series



Mini LED Wall Pack

Specifications

Specifications	MWP2-xK15W-SAFBR	MWP2-xK20W-SAFBR	MWP2-xK30W-SAFBR
Operating Voltage Range	100–277 VAC		
Total Power Consumption	15 Watts	20 Watts	30 Watts
Amps	54 mA @ 277 VAC	72 mA @ 277 VAC	108 mA @ 277 VAC
Beam Angle	110 degree		
Photocell Operation	Turns on when ambient light decreases below 25 lx, turns off when ambient light increases back above 130 lx		
Operating Temperature	-4–113° F (-20–45° C)		
IP Rating	IP65		
Dimmable	No, photocell operated on/off function only		
Fixture Weight	2 lbs (0.91Kg)		

Safety Notes

- Product should be installed by a certified electrician in accordance with applicable national, state, and local building and electrical codes.
- To reduce the risk of electric shock, ensure that the main power source and circuit breakers are switched off before performing any installation or wiring procedures.
- Avoid looking directly into the lamp when illuminated.
- Ensure all mounts are securely attached and will support the weight of the fixture. Failure to properly support the fixture may result in damage or injury, for which the manufacturer does not assume responsibility.

Included Parts

- 1 - mini LED wall pack
- 1 - foam mounting gasket
- 3 - wire nuts

Disabling Photocell Operation

To disable photocell, cut either wire from photocell to driver and cap wire ends.
To re-enable photocell operation, reconnect wire from photocell to driver.

Wire Diagram

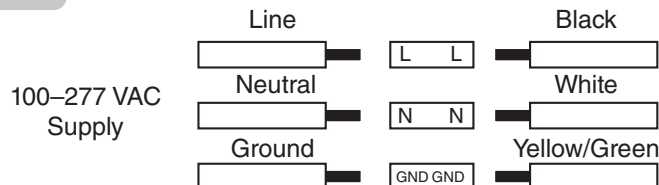

Mini LED Wall Pack

Opening Fixture

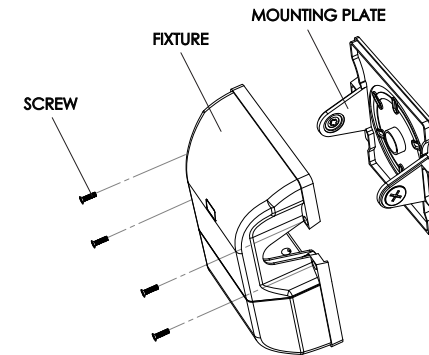

Junction Box Installation

