

Important: Read all instructions prior to installation.

Mini LED Wall Pack

Wall and Conduit Installation Instructions

1. Remove power from circuit.
2. Remove 2 plastic thumb screws from both sides of the light. Remove mounting bracket from light. Peel adhesive film from Foam Gasket and stick to mounting bracket, while lining up the cut-outs.

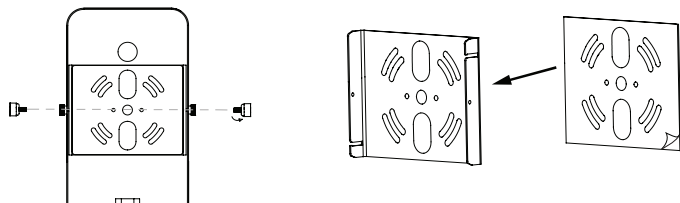

3. Drill 2 holes on the wall using bracket as a guide for holes. Drive wall anchors into holes. Attach mounting bracket to wall using 2 screws (not provided).

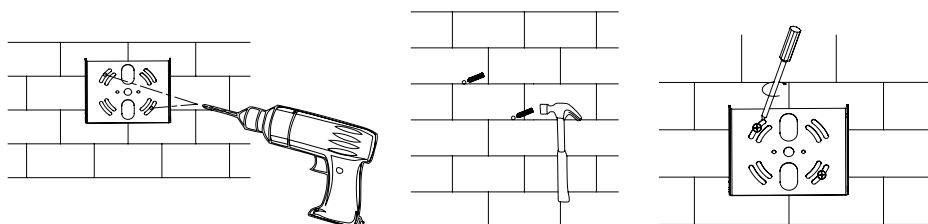

4. Remove knockout from bottom of light. Pull wires from conduit through knockout and make wire connections to main supply. Attach conduit onto light.

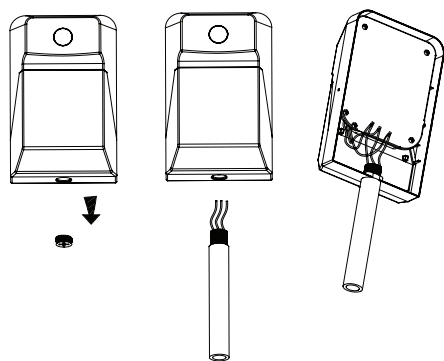

5. Attach light to bracket and tighten 2 plastic thumb screws.

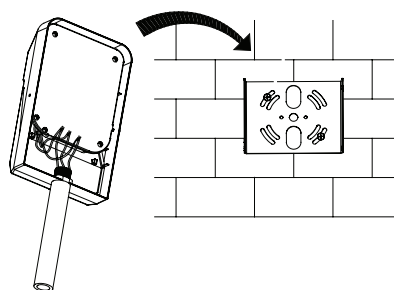

Mini LED Wall Pack

User Manual

Part Number:

MWP-40K20, MWP-40K20-S, MWP-50K20, MWP-50K20-S



Mini LED Wall Pack

Included Parts

- 1 - Mini LED Wall Pack
- 1 - Foam Gasket

Warnings

THIS FIXTURE MUST BE WIRED IN ACCORDANCE WITH THE NATIONAL ELECTRIC CODE AND APPLICATION LOCAL CODES OR ORDINANCES. ALL WORK SHOULD BE PERFORMED BY A QUALIFIED ELECTRICIAN.

Specifications

MWP-40K20 / MWP-40K20-S / MWP-50K20 / MWP-50K20-S	
Intensity	2300 lm
Operating Voltage Range	100~277 VAC
Total Power Consumption	20 Watts
Current Draw	200mA @ 120VAC
Color Temperature	4000K,5000K
Beam Angle	110 degree
CRI	>80
IP Rating	IP65
Power Factor	>0.90
Dimmable	No
Weight	1.81 lbs (0.82kg)
Standards And Certifications	UL
Warranty	5 year

Wire Diagram

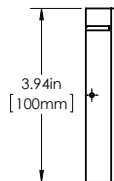
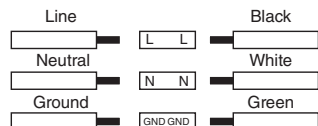

Dimensional Drawings

Mini Wall Pack Dimensions

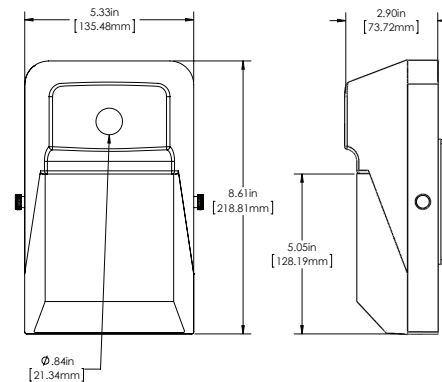

Bracket Dimensions

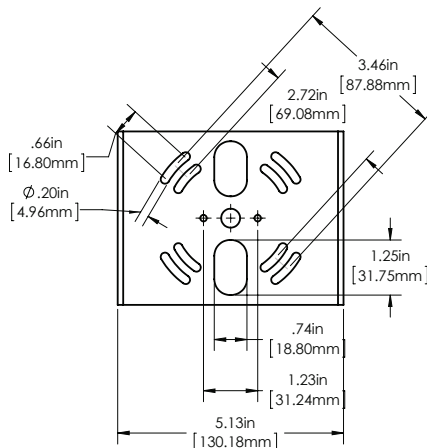

Mini LED Wall Pack

J-Box Installation Instructions

1. Remove power from circuit.
2. Remove 2 plastic thumb screws from both sides of the light. Remove mounting bracket from light. Peel adhesive film from Foam Gasket and stick to mounting bracket, lining up the cut-outs.

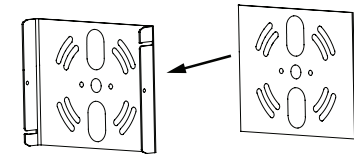
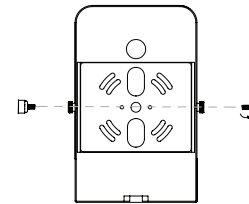

3. Mount bracket to J-box with 2 screws (not included). Pull wires from J-box through bracket.

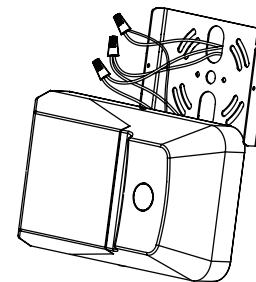
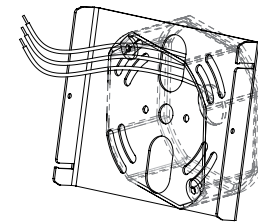

4. Use slots to temporarily hang light on mounting bracket to J-box. Make wire connections to main supply. Push connected wires through bracket into J-box.

Note: Wire connections can stay within light.

5. Mount light on bracket. Secure with 2 plastic thumb screws on both sides.

