

## Installation: Ceiling Flush Mount

Mount model **MD-SM2**

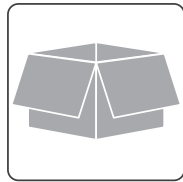

### Step 1

Open the box and make sure the fixture was not damaged during shipping. Power on and confirm the fixture functions properly.

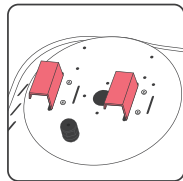

### Step 2

Remove I-Hook (Refer to pg. 1 Figure 1A & 1B). Check and confirm the ceiling mounting brackets are fixed solidly with the fixture.

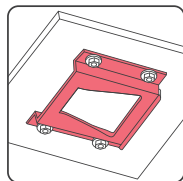

### Step 3

Fix the ceiling mounting board onto the correct installation location.

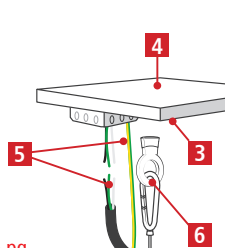

### Step 4

Hang the light fixture onto the mounting board via the hanger as hanging angle demands.

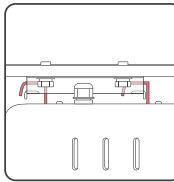

### Step 5

Connect the fixture wires to the corresponding wires in the junction box.

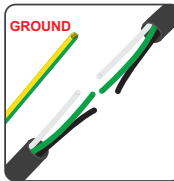

### Step 6

Affix the safety cable to a secondary location.

## Specifications

Power Factor .....	≥ 0.95
Input Voltage .....	AC 100~277V
Power Frequency .....	47~63Hz
Total Harmonic Distortion .....	≤ 15%
Luminaire Efficiency (IES) .....	≥ 100 lm/W
CRI .....	≥ 70
Color Temperature .....	4500~5500K
Beam Angle .....	120°
IP Rating .....	IP65/IP67
Working Ambient Temp .....	-30°~+60°C
Working Ambient Humidity .....	15%~90%RH
Life Span .....	≥ 50,000 Hrs
Light Fixture Material .....	Aluminum Alloy

## Troubleshooting & Solutions

- Not Working
  - Check whether the wires are properly connected. If not, reconnect the wire.
  - If power supply fails, replace with new qualified power supply.
  - If LED module is damaged, replace with new LED module.
- LED Dimming/Flashing
  - The output of the power supply is abnormal. Replace with new power supply.
  - LED module failure. Replace with new LED module.

## Warranty

- This product has a 5 year warranty. During this time, Super Bright LEDs takes responsibility for its manufacturing defects, not for the cost of installation.
- During the warranty, the client shall send the failed parts by carrier for inspection and repair. After inspection and repair, the supplier shall send the fixed parts or new parts back. Each party shall bear the freight cost accordingly.
- The following conditions are not covered by the warranty, and the supplier provides maintenance services by charging maintenance fee:
  - All human factor damages, including damages from operation, usage, storage nonconformity with the instruction manual, abnormal working condition etc.
  - Dismantling, maintenance, modification or unqualified repairing for the products without the supplier's authorization.
  - No warranty cards and documents.
  - Damages caused by user's improper delivery or due to force majeure (including fire, flood, thunder hit, earthquake etc.).

## Note

- Disconnect the power before installing the lamp or replacing accessories.
- Ensure the input voltage is within specifications of the fixture.
- Suitable wire diameter on the AC junction box is 7.5mm~14mm.

**superbrightleds.com**  
LED Lighting For Everything

## Instruction Manual MD-Series Modular LED High Bay Lights

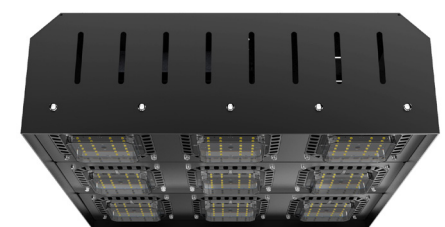

**Super Bright LEDs**  
St. Louis, MO 63045  
866-590-3533 USA  
superbrightleds.com

REV 2.6.2014

# Instruction Manual

## MD-Series

### Modular LED High Bay Lights

**Warning:** Please read instruction manual before installation and keep for your records.

- Installation should be performed by qualified professionals to local code.
- Turn power off at main breaker before installation or performing any maintenance of the fixture panel.

#### Opening Fixture

Figure 1A

Remove all six screws and lift lid to access internal components and mounting hardware.

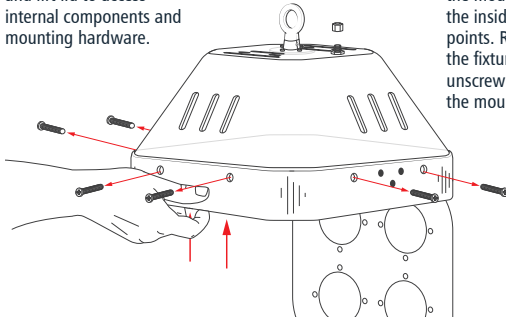

#### Replace Mounting Hardware

After opening the housing, locate the mounting hardware from both the inside and outside access points. Remove the 4 screws from the fixture, and 1 set screw to unscrew the I-Hook and release the mount.

Figure 1B

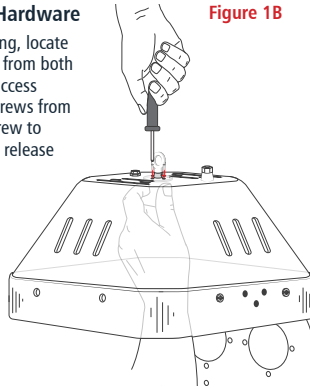

#### Installation: I-Hook

Mount model **MD-IBM**

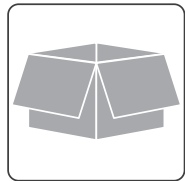

##### Step 1

Open the box and make sure the fixture was not damaged during shipping. Power on and confirm the fixture functions properly.

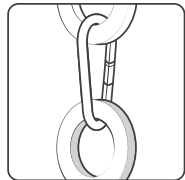

##### Step 2

Hang the fixture by attaching the I-Hook to an existing hook, or use the included carabiner if required.

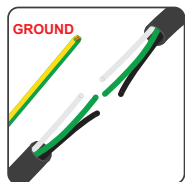

##### Step 3

Connect the fixture wires to the corresponding wires in the junction box.

##### Step 4

Affix the safety cable to a secondary location.

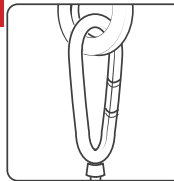

##### Step 5

Double check steps to ensure everything is properly secured, and power on.

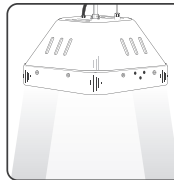

#### Installation: Threaded NPT

Mount model **MD-CM12**

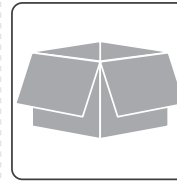

##### Step 1

Open the box and make sure the fixture was not damaged during shipping. Power on and confirm the fixture functions properly.

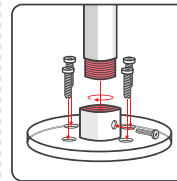

##### Step 2

Remove I-Hook (Refer to pg. 1 Figure 1A & 1B), and install the NPT connector. Thread the conduit onto the NPT connector. Fasten the set screw.

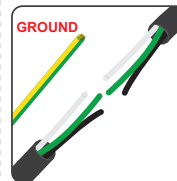

##### Step 3

Connect the fixture wires to the corresponding wires in the junction box.

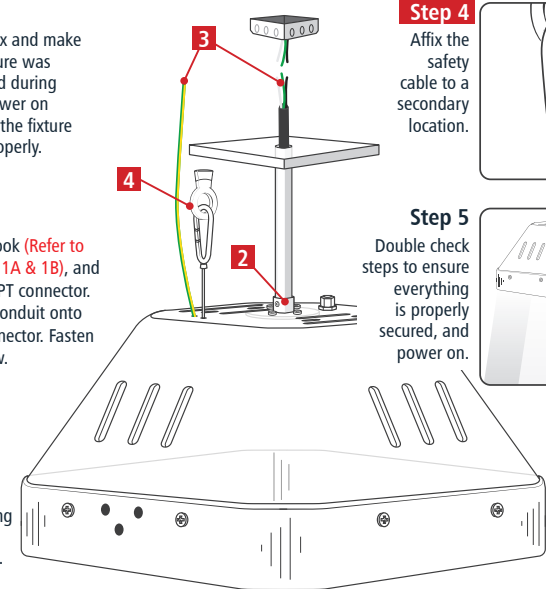

##### Step 4

Affix the safety cable to a secondary location.

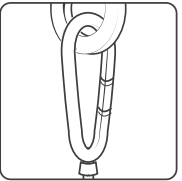

##### Step 5

Double check steps to ensure everything is properly secured, and power on.

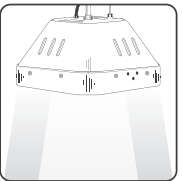

#### Installation: Swivel Bar Mount

Mount model **MD-UB2**

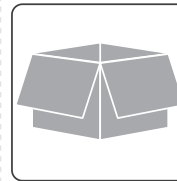

##### Step 1

Open the box and make sure the fixture was not damaged during shipping. Power on and confirm the fixture functions properly.

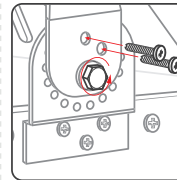

##### Step 2

Remove I-Hook (Refer to pg. 1 Figure 1A & 1B). Remove the angle locking screws; loosen the bolt on the bracket.

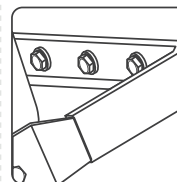

##### Step 3

Affix the hanging bracket to the appropriate installation location.

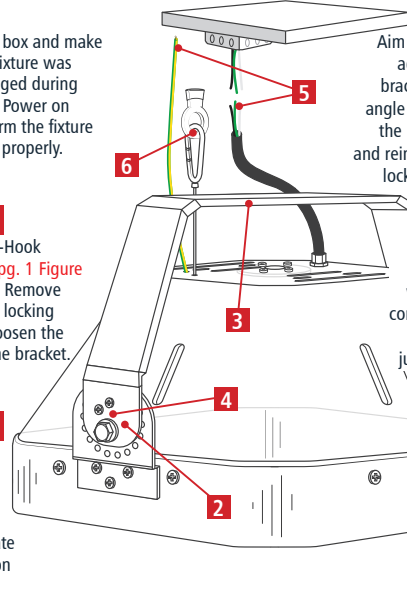

##### Step 4

Aim the light by adjusting the bracket. Set the angle by securing the bracket bolt and reinstalling the locking screws.

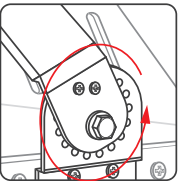

##### Step 5

Connect the fixture wires to the corresponding wires in the junction box.

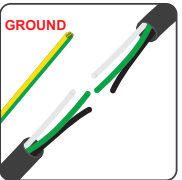

##### Step 6

Affix the safety cable to a secondary location.

