

Important: Read all instructions prior to installation.

Linear LED Strip Light Fixture

Included Parts

- 1 - Linear Strip Light
- 1 - Surface Mounting Kit
- 1 - Junction Box Mounting Kit

Specifications

Check product label for specific electrical specifications related to installation.
Improper installation will void warranty.



LSFD-xK4-40-3G

Safety and Notes

- Product should be installed in accordance with applicable national, state, and local building and electrical codes.
- To reduce the risk of electric shock, ensure that the main power source and circuit breakers are switched off before performing any installation or wiring procedures.
- Avoid looking directly into the lamp when illuminated.
- Ensure all mounts are securely attached and will support the weight of the fixture.
- Failure to properly support the fixture may result in damage or injury, for which the manufacturer does not assume responsibility.

Installation Instructions (Surface Mount)

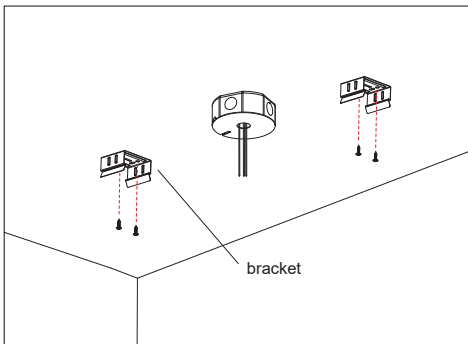

1. Measure distance between brackets on light. Drill appropriate holes and securely mount included brackets.

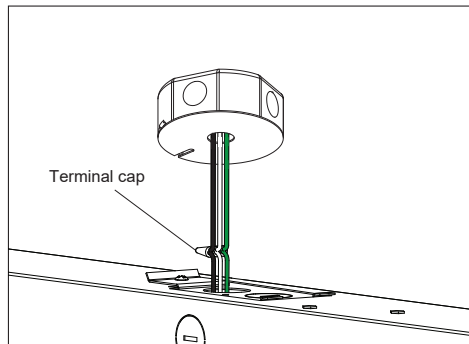

2. With supply power off, connect wiring.

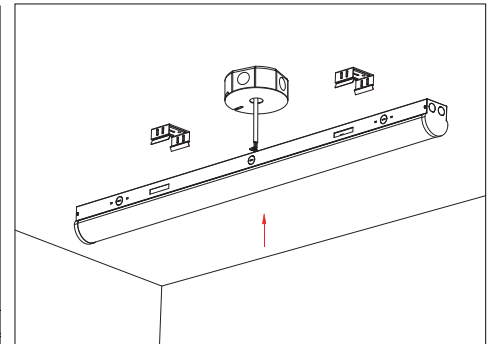

3. Insert light into brackets until securely locked in place.

Installation Instructions (Junction Box Mount)

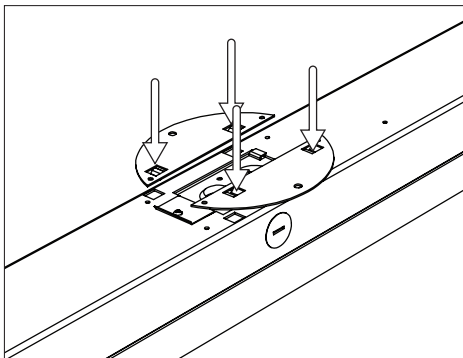

1. Slide mounting bracket plates onto fixture.

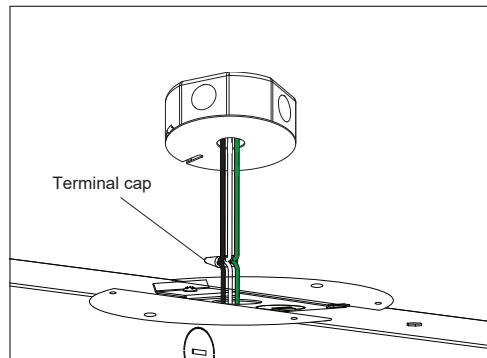

2. With supply power off, connect wiring.

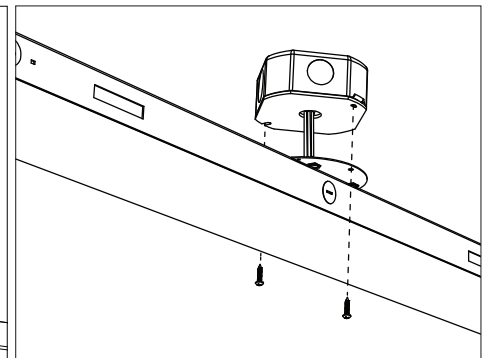

3. Screw mounting plates to junction box (screws not included).

Important: Read all instructions prior to installation.

Linear LED Strip Light Fixture

Optional Accessories

LSFD-HK - Hanging Kit

Installation Instructions (optional hanging kit)

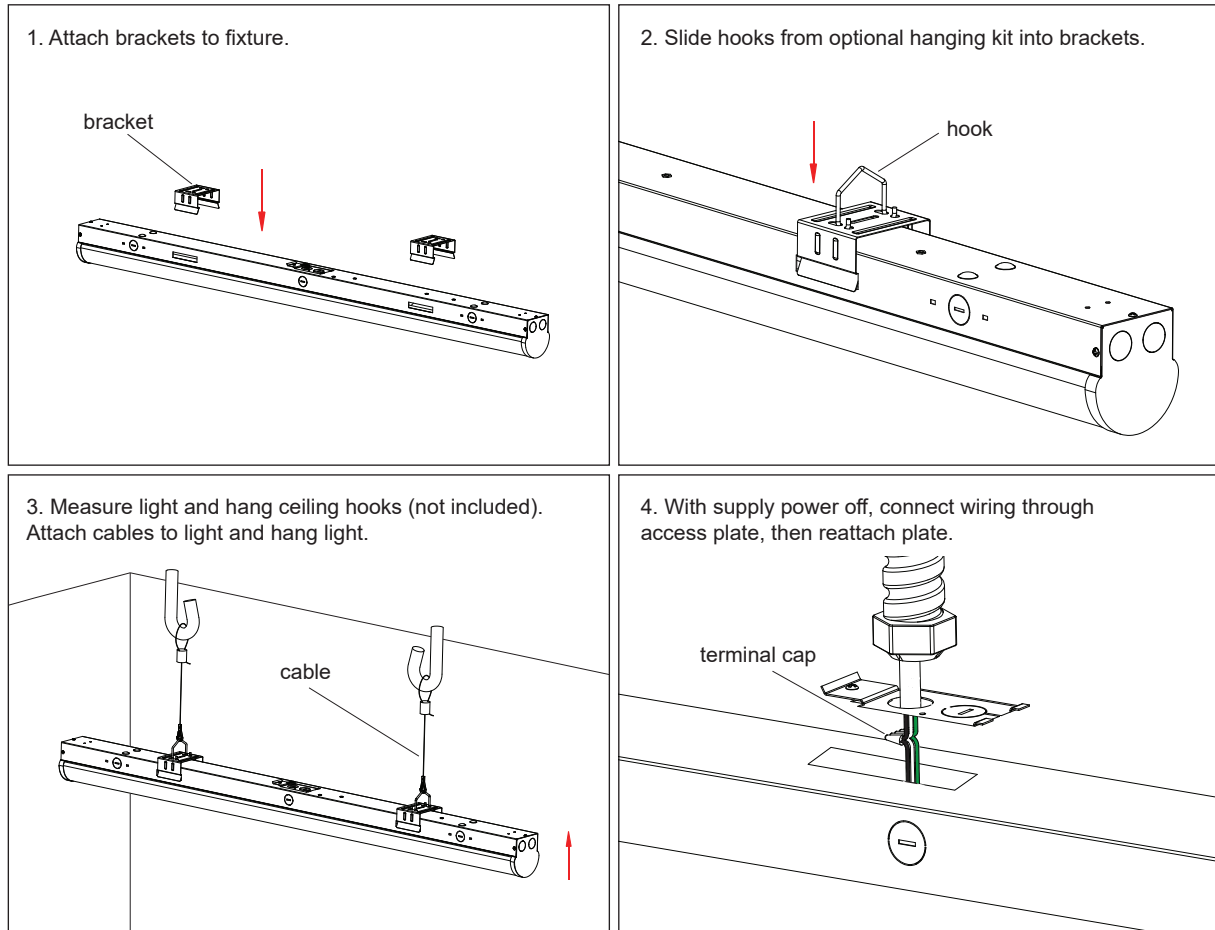

Wiring Diagram

