

Important: Read all instructions prior to installation.

LED Canopy/Parking Garage Light

Surface Mounting Installation

1. Loosen 4 retaining screws and pull back plate from light. Once loose, detach safety cable.
2. Remove conduit plug, drill holes through back panel, and mount to junction box.
Note: Any holes drilled in back plate will need to be properly sealed.
3. Connect wiring.
4. Reattach safety cable.
5. Place light over back plate and retighten four retaining screw until tight.
Note: Screws will not thread in until flush, do not overtighten.

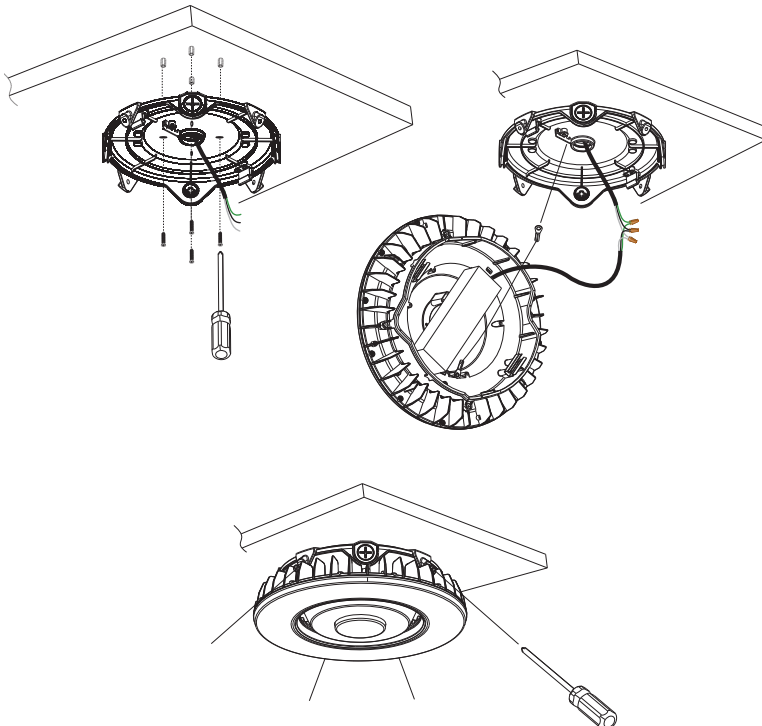
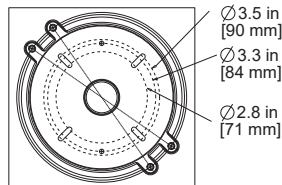
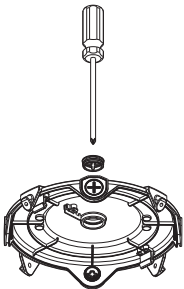

LPGD-xK55W-111WH-S

Specifications

Model	LPGD-xK55W-111WH and LPGD-xK55W-111WH-S	LPGD-xK100W-111WH and LPGD-xK100W-111WH-S
Wattage	55 W	100 W
Operating Voltage Range	100–277 VAC	
Light Distribution	Type V	
Operating Temperature	-40°–122° F (-40°–50° C)	
IP Rating	IP65	
Dimmable	1–10V on non-motion sensor models, 0–10 V on models equipped with preinstalled motion sensor (controlled through sensor only).	
Weight	4 lb (1.8 kg)	6.6 lb (3 kg)

Wiring Diagram

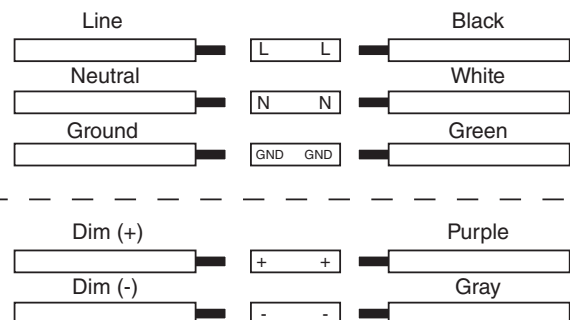

Note: Dimming function is not available on models equipped with motion sensor.

Important: Read all instructions prior to installation.

LED Canopy/Parking Garage Light

Conduit Installation

1. Loosen 4 retaining screws and pull back plate from light. Once loose, detach safety cable.
2. Remove desired conduit plug(s).
3. Attach conduit to back plate. Drill mounting holes through back plate for additional mounting support as needed.

Note: Any holes drilled in back plate will need to be properly sealed.

4. Connect wiring.
 5. Reattach safety cable.
 6. Place light over back plate and retighten four retaining screw until tight.
- Note: Screws will not thread in until flush, do not overtighten.

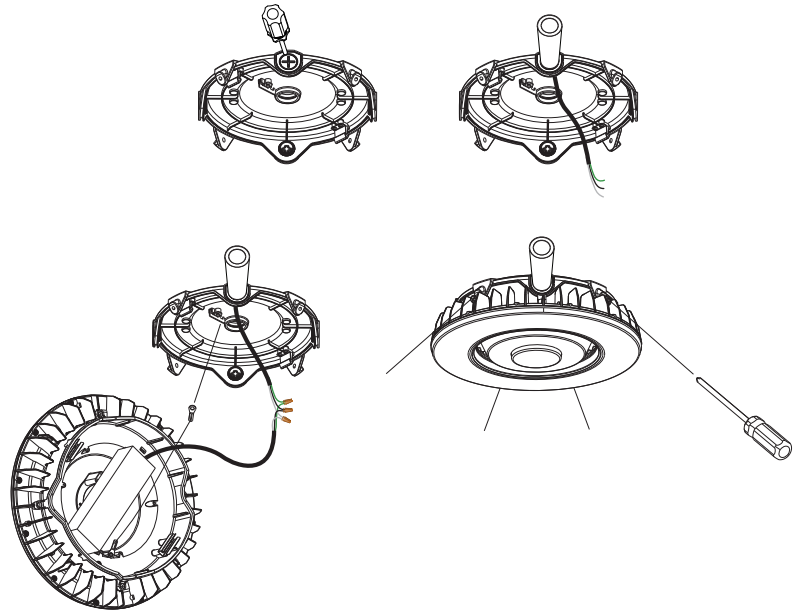

Pole/Pendant Mounting Installation

1. Loosen 4 retaining screws and pull back plate from light. Once loose, detach safety cable.
2. Remove conduit plug and attach pipe to back plate.
3. Connect wiring.
4. Reattach safety cable.
5. Place light over back plate and retighten four retaining screw until tight.

Note: Screws will not thread in until flush, do not overtighten.

