

Important: Read all instructions prior to installation.

Tunable White LED Panel Light

Drop Ceiling Installation

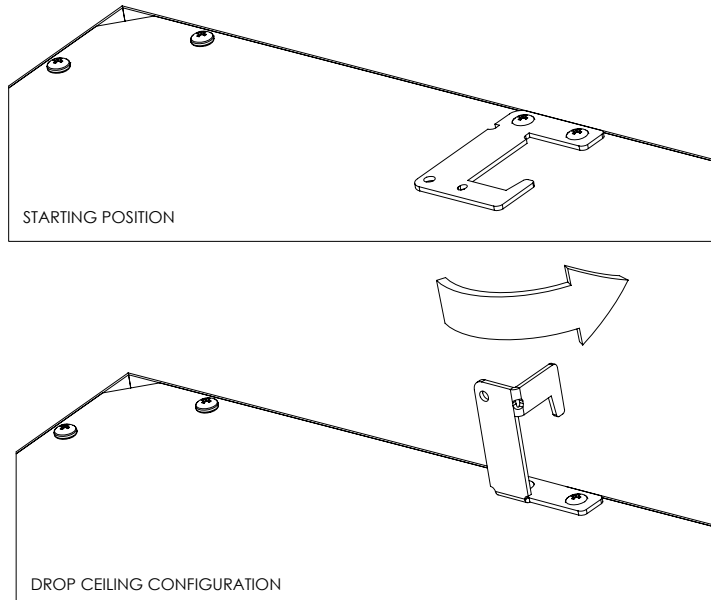

Suspension Kit Installation (LP-HKO-2)

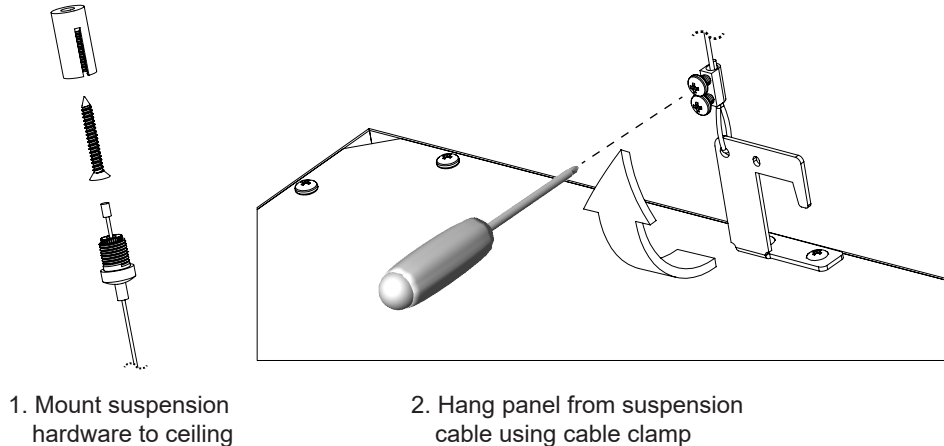

1. Mount suspension hardware to ceiling

2. Hang panel from suspension cable using cable clamp

User Manual

LPD-TWR22-40

LPD-TWR24-50

LPD-TWR24-72



Included Parts

- 1 - LED Panel Ceiling Light
- 4 - Wire Nuts

Recommended Accessories

- Handheld Remote Control (LPD-TWHR)
- Wall-mount Controller (LPD-TWWR)
- Optional Suspension Kit (LP-HKO-2)
- Surface Mount Kit (LP-22-SMK, LP-24-SMK)

Safety and Notes

- Product should be installed by a certified electrician in accordance with applicable national, state, and local building and electrical codes.
- To reduce the risk of electric shock, ensure that the main power source and circuit breakers are switched off before performing any installation or wiring procedures.
- Avoid looking directly into the light when illuminated.
- Failure to properly support the fixture may result in damage or injury, for which the manufacturer does not assume responsibility. A safety cable is not included, but it is recommended that one be connected to grid clip during installation.

Recessed Installation

1. Turn off power and remove existing troffer light or ceiling tile.
2. Open driver box and remove knockout(s) on driver box. Make electrical connections inside of driver box as shown in FIG 1. Reinstall junction box lid.

FIG 1

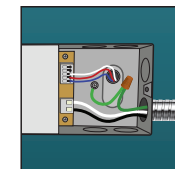
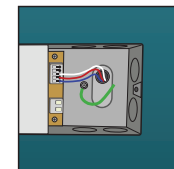
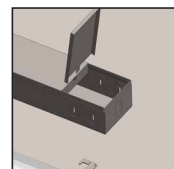

Important: Read all instructions prior to installation.

Tunable White LED Panel Light

LPD-TWR22-40
LPD-TWR24-50
LPD-TWR24-72

Controllers



ON OFF	ON Turn on OFF Turn off
OFF	Turn off the light to save the current color temperature then turn on the light, the last saved color temperature will be displayed by default.
ID	Matching code for light Long pressing the 'ID' button will keep the controller's indicator on, then turn on the light and release the 'ID' button after the light flashes, matching code complete. Matching code for several lights simultaneously is available.
ID + ▼	Release the code and disconnect light from remote controller Press the button ID + ▼ together, then turn on the light, the light will flash to finish releasing the code on the lights.
1 2 3 4	Group selecting button Grouping lights (matching code process needs to be completed first). Turn off the lights, continue pressing the group selection button for 3s, then turn on the lights, the lights will flash to finish grouping.
Save	Save button Long pressing (3-5 seconds) the button "SAVE" until the light goes out, the current brightness and color temperature are automatically saved. Turn off lights then turn on, the last saved brightness and color temperature will be displayed by default.
ALL	All Groups are selected
25% 50% 75% 100%	25% brightness 75% brightness 50% brightness 100% brightness
▲ ▼	Increase brightness Decrease brightness ▲ Decrease color temperature ▼ Increase color temperature



ON OFF	ON Turn on OFF Turn off
ON	Long pressing (6-9 seconds) the button "ON" until the light goes out, the current brightness and color temperature are automatically saved. Turn off lights then turn on, the last saved brightness and color temperature will be displayed by default.
OFF	Turn off the light to save the current color temperature then turn on the light, the last saved color temperature will be displayed by default.
ON + OFF	Light code combination matching button Pressing the 'ON + OFF' buttons simultaneously will keep the remote controller's indicator on, turn on the light and release the buttons after the light has been on for 2s completing the matching process. Matching code for several lights together is available. If you need to use both hand-hold controller and wall controller for the same light, please don't use this function, directly use the following copy function.
CCT	Press the 'CCT' button, the color temperature will cycle between 3000k/3500k/4000k/5000k. After shutting down/turning off the current color temperature will be saved.

Wall Controller and Handheld Controller Dual Use

If using both the handheld controller and wall-mount controller, the wall controller can copy some of the functions of the hand-hold controller by holding the following buttons simultaneously for a few seconds until indicator light turns solid.

NO.	Grouping	Hand-hold controller	Wall-type controller
1	1	1 + ID	ON+CCT
2	2	2 + ID	ON+CCT
3	3	3 + ID	ON+CCT
4	4	4 + ID	ON+CCT
5	All	ID	ON+CCT

Wiring Diagrams

