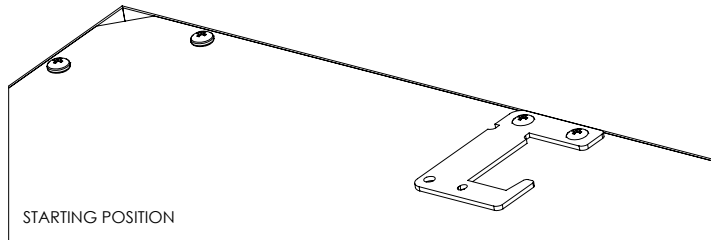

Important: Read all instructions prior to installation.

Tunable White LED Panel Light

LPD-TWR22-40
LPD-TWR24-50
LPD-TWR24-72

Drop Ceiling Installation

STARTING POSITION

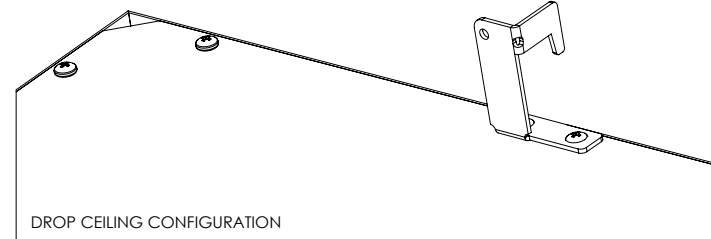

DROP CEILING CONFIGURATION

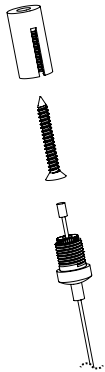
Suspension Kit Installation (LP-HKO-2)

1. Mount suspension hardware to ceiling

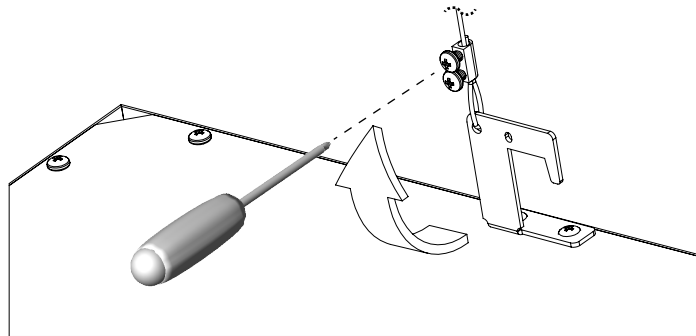

2. Hang panel from suspension cable using cable clamp

Tunable White LED Panel Light

LPD-TWR22-40

LPD-TWR24-50

LPD-TWR24-72

Installation Manual

Important: Read all instructions prior to installation.

Tunable White LED Panel Light

Included Parts

- 1 - LED Panel Ceiling Light
- 4 - Wire Nuts

Recommended Accessories

- Tunable White Remote Control (LPD-TWHR)
- Wall Switch 2.4G Wireless (LPD-TWWR)
- Optional Suspension Kit (LP-HKO-2)
- Surface Mount Kit (LP-22-SMK, LP-24-SMK)

Safety and Notes

- Product should be installed by a certified electrician in accordance with applicable national, state, and local building and electrical codes.
- To reduce the risk of electric shock, ensure that the main power source and circuit breakers are switched off before performing any installation or wiring procedures.
- Avoid looking directly into the light when illuminated.
- Failure to properly support the fixture may result in damage or injury, for which the manufacturer does not assume responsibility. A safety cable is not included, but it is recommended that one be connected to grid clip during installation.

Recessed Installation

- Turn off power and remove existing troffer light or ceiling tile.
- Open driver box and remove knockout(s) on driver box. Make electrical connections inside of driver box as shown in FIG 1. Reinstall junction box lid.

FIG 1

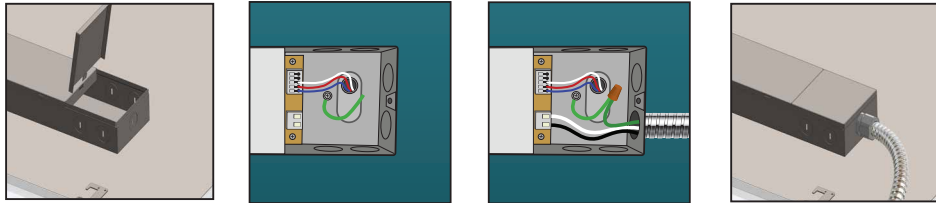

Remote

HANDHELD REMOTE CONTROLLER



ID	Matching a Group of Lights to Remote Turn off power to grouping of lights. Hold ID button for 3 seconds and then apply power to lights. The group of lights will now be matched to the remote. (4 groups of lights can be matched to the handheld remote.)
ID + ▾	Unmatching a Group of Lights Hold ID ▾ buttons then turn off power to group of lights. They will now be unmatched from the remote.
1 2 3 4	Group Selection Button After a group has been matched to the remote you can assign the group a number. Disconnect power to the group. Then hold the number you want to assign to it for 3 seconds and turn power back on to the group.
⌚	Delayed Turn Off Press the ⌚ button and the group of lights will flash once and then turn off after 10 seconds.
⊗	All Groups are selected
Color temperature selecting/setting	
6000K	3000K
25% brightness	100% brightness
▲ Increase brightness	▼ Decrease brightness
⊗ Decrease color temperature	⊕ Increase color temperature

Wireless Wall Switch



THE WALL TYPE REMOTE CONTROLLER

ON OFF	ON Turn on OFF Turn off
ON + OFF	Matching a Group of Lights with Remote Turn off power to grouping of lights. Hold ON + OFF buttons simultaneously for 2 seconds and then apply power to lights. The group of lights will now be matched to the remote. (Only one group of lights can be controlled with the wall type remote.)
Brightness adjustment	
CCT	This will rotate the light or group of lights between 3000K/3500K/4000K/5000K. When lights are turned off the CCT is saved.

Wiring Diagrams

