

Important: Read all instructions prior to installation.

LED Linear High Bay with Motion Sensor



Included Parts

- 1 - LED Fixture
- 1 - Hanging Kit
 - 2 - Steel Cable
 - 6 - Carabiners

Safety and Notes

- This product should be installed by a certified electrician in accordance with applicable national, state, and local building and electrical codes.
- To reduce the risk of electric shock, ensure that the main power source and circuit breakers are switched off before performing any installation or wiring procedures.
- Avoid looking directly into the lamp when illuminated.
- Ensure all mounts are securely attached and will support the weight of the fixture. Failure to properly support the fixture may result in damage or injury, for which the manufacturer does not assume responsibility.

Microwave Motion Sensor

Refer to the separate motion sensor guide for details on sensor setup and operation. Dimming is only available through use of the motion sensor.

Note: There is also a label displaying DIP switch setup on the fixture itself.

Installation Instructions

Electrical

1. Access the electrical cable by loosening or removing four Phillips screws to slide back or remove the access plate on top of unit. (FIG 1)

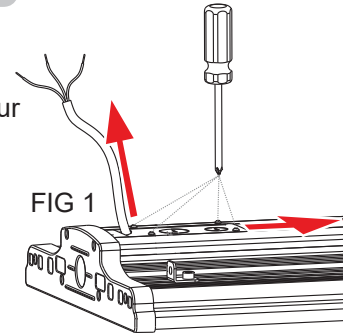

2. Electrical connection will vary by application.

Conduit to Access Plate

Route conduit to one of two knockouts on access plate and connect wires on the internal side of the plate with appropriate hardware. (FIG 2A)

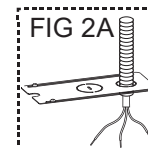

Cable to Junction Box

Route the existing 30-inch cable to junction box near the fixture, making sure cable and connection are secure. Use the notch at end of the access plate to hold cable in proper position. (FIG 2B)

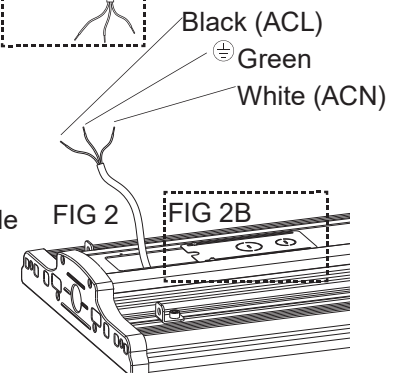

3. Ensure access plate is secured in place by reinstalling/tightening four Phillips screws.

Important: Read all instructions prior to installation.

LED Linear High Bay with Motion Sensor

Mounting Instructions

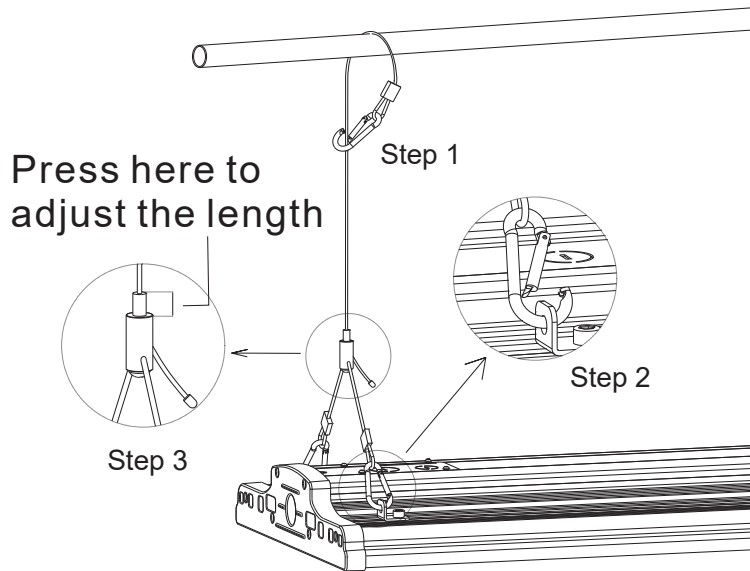

External Dimmer Bypass Instructions

1. Remove hardware to gain access to wiring.
2. Disconnect both sets of black and white wires from motion sensor and connect them to each other, bypassing motion sensor.
3. Disconnect the purple and grey wires from motion sensor and wire to external dimming wires.
4. Remove 4 Phillips screws that hold motion sensor bracket in place and remove motion sensor assembly.

