

Important: Read all instructions prior to installation.

LED Dock Light

Safety and Notes

- Product should be installed and serviced in accordance with applicable national, state, and local building and electrical codes.
- Avoid looking directly into lamp when illuminated.
- Ensure all mounts are securely attached and will support the weight of the fixture. Failure to properly support fixture may result in damage or injury, for which the manufacturer does not assume responsibility.
- Light must be connected to GFCI-protected receptacle.

Included Parts

LDL-50K60-36-armkit

LDL-50K60-36 - Light Head
LDL-MA-40 - Steel Arm

LDL-50K60-36-cordkit

LDL-50K60-36 - Light Head
LDL-A2 - Cord

Specifications (Light Head)

Specifications	LDL-50K60-36
Voltage	120 VAC
Total Power Consumption	60 W
Current Draw	0.5 A @120 VAC
Beam Angle	NEMA 3x3 (36° x 36°)
Operating Temperature	-22°-122° F (-30°-50° C)
Environmental Rating	IP65
Dimmable	No



LDL-50K60-36-armkit

Installation Instructions (LDL-50K60-36-cordkit)

1. Drill holes as needed and mount bracket to existing arm or structure.
2. Mount bracket to structure and route power cord.

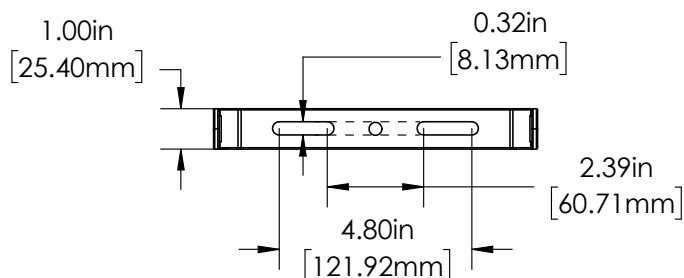

Installation Instructions (LDL-50K60-36-armkit)

1. Drill holes for mounting arm to secure structure.

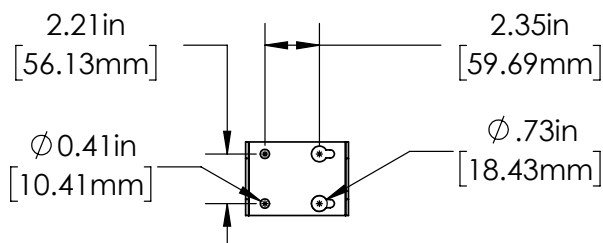

2. Mount arm to structure and route power cord.
3. Securely attach light to arm. Connect power cord to light.
Note: When installing light head on existing arm/bracket, the power cord will need to be routed to avoid potential damage or hazards.

