

Important: Read all instructions prior to installation.

Linear Explosion Proof Light



EPLL2-50K75-4 w/ optional EPLL2-CM

Safety and Notes

- Product should be installed by a certified electrician in accordance with applicable national, state, and local building and electrical codes. Proper earth grounding is required.
- To reduce the risk of electric shock, ensure that the main power source and circuit breakers are switched off before performing any installation or wiring procedures. If smoke is detected or a short circuit is present, switch off power immediately and notify relevant personnel.
- Avoid looking directly into the light when illuminated.
- Failure to properly support the fixture may result in damage or injury, for which the manufacturer does not assume responsibility. Check whether any accessories are correctly installed prior to installation.
- If the light is damaged during shipping, do not install and contact customer service immediately.

Specifications

Model	EPLL2-50K75-4
Operating Temperature	-40°–131° F (-40°–55° C)
IP Rating	IP66
Fixture Weight	17 lb (7.7 kg)

Check product label for specific electrical specifications related to installation. Improper installation will void warranty.

Wiring Diagram

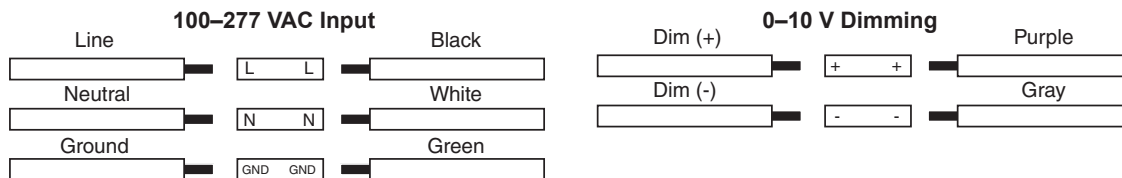

Standard Surface Mount Installation (included)

1. Slide mounting brackets to desired position and lock in place with the set screw.
Note: Do not mount with either bracket more than 9 in. from their respective end of the light.
2. Use mounting bracket to mark and create mounting holes.
3. Mount light to surface.
4. With supply power off, connect wiring.
5. Attach conduit, making sure to it seal properly to maintain explosion proof rating.

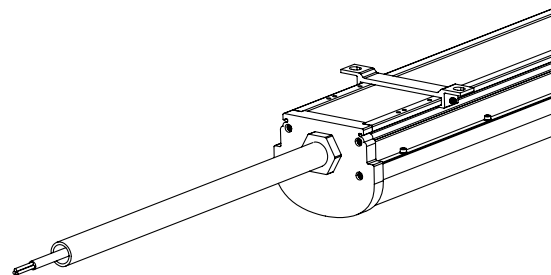
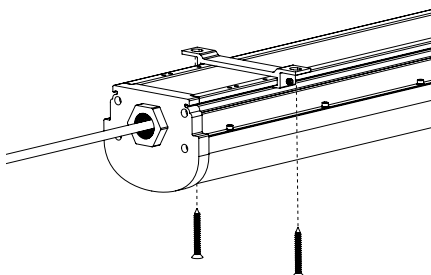

Rev Date: V1 08/06/2021

4400 Earth City Exp, St. Louis, MO 63045

• 866-590-3533

• superbrightleds.com

Important: Read all instructions prior to installation.

Linear Explosion Proof Light

Pole Mount Installation (optional EPLL2-PM)

Important: Unless your light has had them removed, the standard installed bracket is identical to the lower bracket from this kit, meaning the one from the kit can be discarded after successful installation.

1. Slide mounting brackets to desired position and lock in place with the set screw.
Note: Do not mount with either bracket more than 9 in. from their respective end of the light.
2. Use the curved clamping side of the accessory kit and the provided hardware to attach the light a suitable pipe/pole that can support the light's weight.
Note: Maximum pole diameter is 2.375 in (60 mm)
3. With supply power off, connect wiring.
4. Attach conduit, making sure to it seal properly to maintain explosion proof rating.

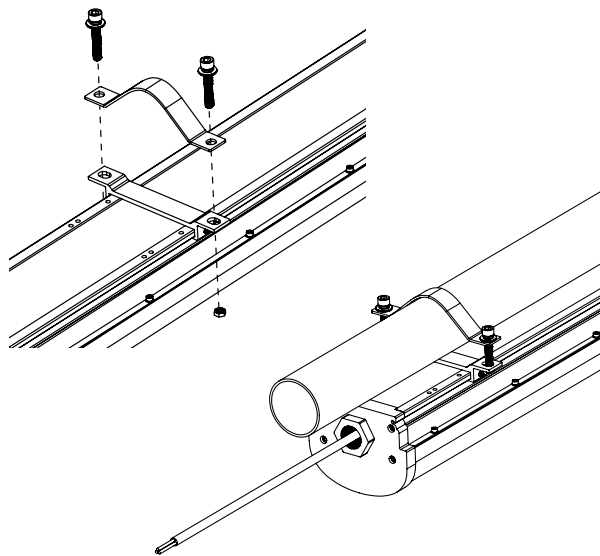

Suspension Installation (optional EPLL2-HM)

1. Slide installed mounting brackets to the end of the light and lock in place with the set screw.
2. Attach hanging brackets to light using provided hardware.
3. Mount hooks (not included) to hang light from approximately 39.375 in. (1 m) apart.
4. Attach chain to light and hang light from the hooks.
5. With supply power off, connect wiring.
6. Attach conduit, making sure to it seal properly to maintain explosion proof rating.

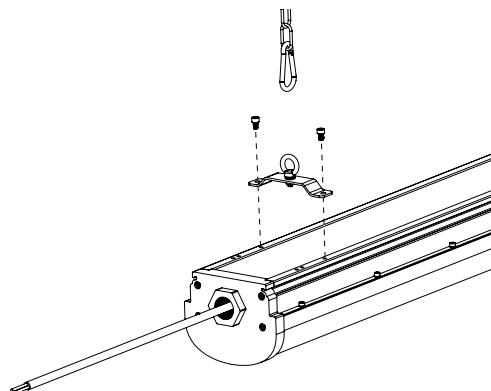

Adjustable Surface Mount Installation (optional EPLL2-CM)

1. Slide installed mounting brackets to the end of the light and lock in place with the set screw.
2. Assemble mounting bracket and attach to light.
3. Use assembled fixture to mark mounting hole locations.
4. Create mounting holes in surface.
5. Remove surface side of mounting bracket from light and mount it.
6. Mount light by reinstalling the center mount hardware to reassemble the mounting bracket. At this time the light can be set to the desired angle as well.
7. With supply power off, connect wiring.
8. Attach conduit, making sure to it seal properly to maintain explosion proof rating.

