

Important: Read all instructions prior to installation.

Area Light with Dusk to Dawn Sensor

Parts Included

- 1 - LED Area Light with Sensor
- 1 - Two Section Mounting Pole
- 1 - Mounting Pole Bracket with Bolt

Optional Accessories

- 1 - Shorting Cap (JL-208) sold separately

Specifications

Input Voltage	100-277 VAC
Input Power	50 Watts
Input Current	600mA Max
Lumens	5500
Color Temperature	5000K
CRI	>80
Efficacy	110lm/w
IP Rating	Weatherproof IP 65
Operating Temperature Range	-4°-104°F (-20°~40°C)
Warranty	5 Years

SAFETY INSTRUCTION

- Read instructions carefully before attempting to install fixture. Retain instruction for future reference.
- Disconnect power before installing or servicing. This fixture must be wired in accordance with the National Electrical Code and applicable local codes and ordinances.
- All wiring should be performed by a qualified electrician. This fixture is for outdoor use and should not be used in areas with limited ventilation or high ambient temperatures.

INSTALLATION- Directly fix to mounting surface

1. Do not remove any part of the fixture.
2. Specification please see the label on fixture.
3. Use expansion bolts to secure the fixture on mounting surface. (See Fig. 1&Fig.2)
4. Keep enough length wires to ensure adjusting angle unhindered.
5. Connect wires into wiring terminal; white wire to "Neutral" terminal, black wire to "Live" terminal, green wire to "Ground" terminal;and fix them by screws.
6. Please mention the main specification as following before wiring. (See Table 1)

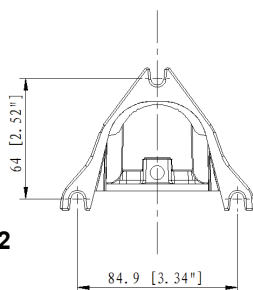

FIG. 2

INSTALLATION- Fix to mounting surface with an arm

1. Connect the wire in same color (correspond to wire N, L and G) together with a wire connector.
2. Put one end of the tube into the U-slot, and then fix the tube with two hex socket screws. Please make sure that the tube will not rotate. (See Fig. 3)
3. Fixed -clamp on the pipe in a right position and make sure that the pipe will not rotate.
4. Install the light fixture on the wall with four screws.

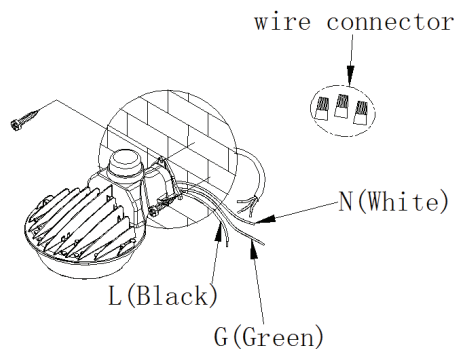

FIG. 1

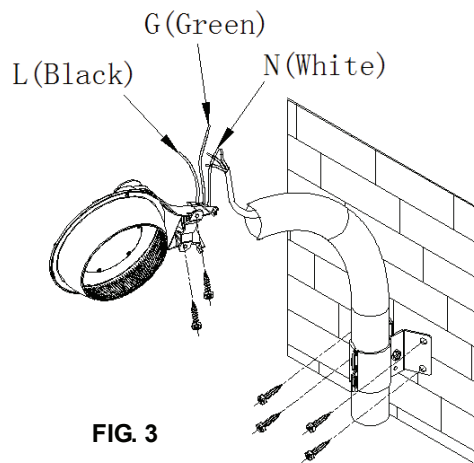

FIG. 3

