

Important: Read all instructions prior to installation.

Commercial Can Retrofit LED Down Light

Dimensional Drawing

DCL8D-x40

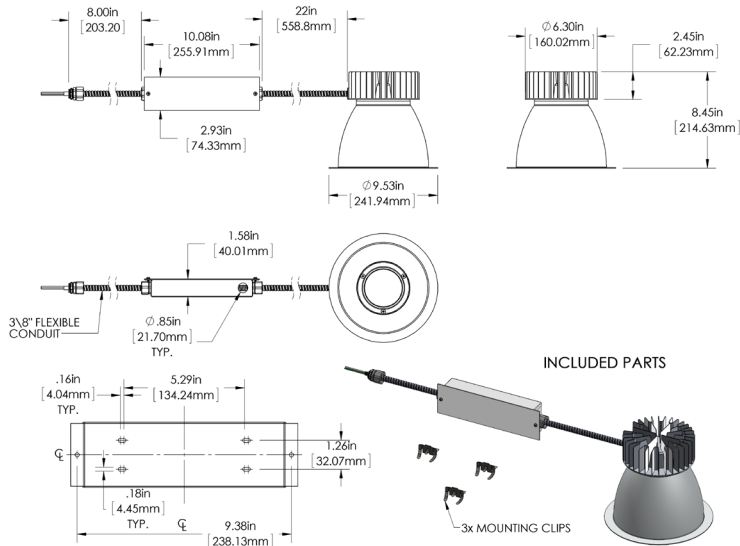

DCL10D-x40

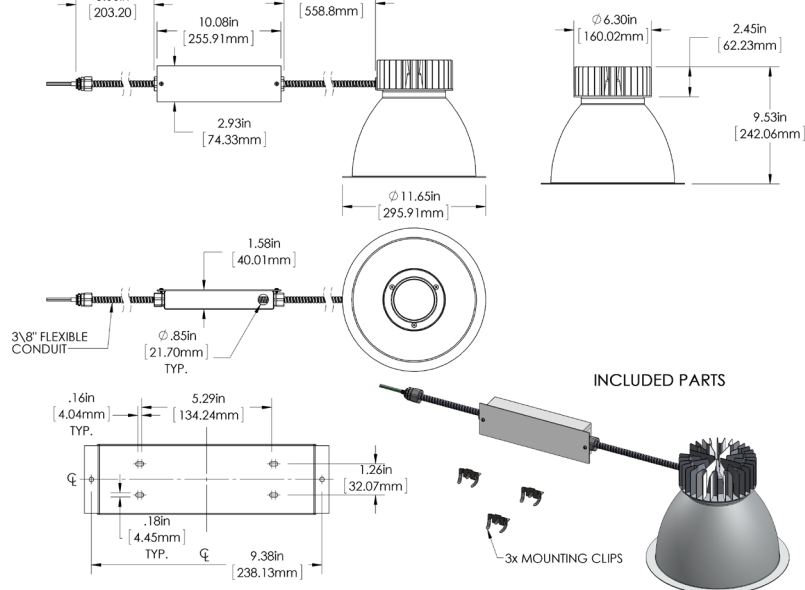

Commercial Can Retrofit LED Down Light

DCLxD-x40

User Manual



Important: Read all instructions prior to installation.

Commercial Can Retrofit LED Down Light

Included Parts

- 1 - LED Down Light Retrofit Fixture with LED Driver
- 3 - Retaining Clips

Safety and Notes

- Product should be installed by a certified electrician in accordance with applicable national, state, and local building and electrical codes.
- To reduce the risk of electric shock, ensure that main power source and circuit breakers are switched off before performing any installation or wiring procedures.
- Avoid looking directly into lamp when illuminated.
- Ensure all mounts are securely attached and will support weight of the fixture. Failure to properly support the fixture may result in damage or injury, for which the manufacturer does not assume responsibility
- For indoor use only. Suitable for installation in damp locations. Avoid direct contact with water and other liquids.
- Clean with a soft damp cloth only, do not use any chemical cleaners.
- This light can only be installed in an existing fixtures meeting the housing requirements listed below.

Housing Compatibility

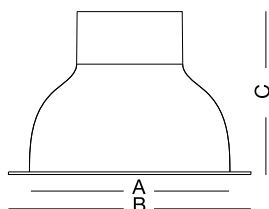

Model No.	A	B	C
DCL10D-NW40	10.05" (255.27 mm)	11.65" (295.91 mm)	9.53" (242.06 mm)
DCL8D-NW40	7.9" (200.66 mm)	9.53" (242.06 mm)	8.45" (214.63 mm)

Installation Instructions

NOTE: RETROFIT KIT IS VOLTAGE SPECIFIC. VERIFY VOLTAGE IS 100~277 BEFORE INSTALLATION

1. Remove power to fixture, then remove existing lamp.
2. Remove and discard existing reflector from mounting frame.
3. Open junction box.
4. Cut all supply wires leading to the ballast. (wires may be removed)
5. Twist out conduit knockout.
6. Place LED Driver box through ceiling cut-out and allow to rest on ceiling.
7. Install driver box supply conduit into the junction box.
8. Connect the supply voltage to LED driver. Black to line, white to neutral.
9. Connect green to ground, close junction box. If using 0~10V dimmer, open driver box and make connections gray to gray, purple to purple.
10. Push reflector up through existing mounting frame. If fixture is loose, install 3 retaining clips on mounting frame.

