

Important: Read all instructions prior to installation.

## 8" and 10" Architectural LED Downlight

### Dimensional Drawing

**DCL8D-NW40**

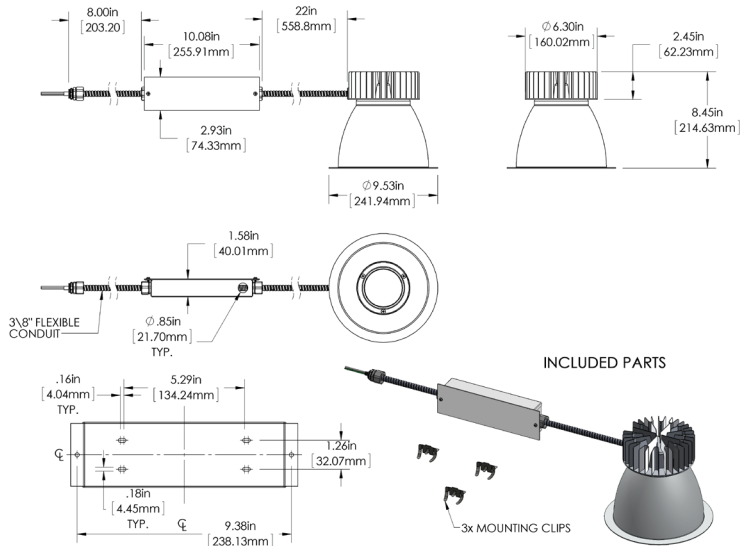

**DCL10D-NW40**

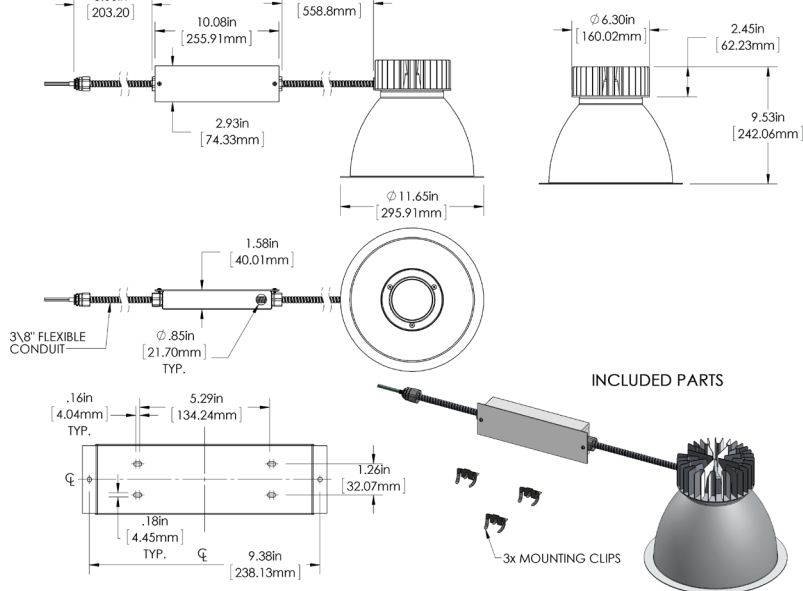

## 8" and 10" Architectural LED Downlight

**DCL10D-NW40**  
**DCL8D-NW40**

### Installation Manual



### Safety and Notes

1. Read all instructions completely before beginning. Keep these instructions for future reference.
2. To reduce risk of fire and over-heating, make sure all connections are tight.
3. Turn off the electrical power before proceeding.



#### CAUTION: Risk of Fire or Electric Shock

LED Retrofit Kit installation requires knowledge of luminaires electrical systems. If not qualified, do not attempt installation. Contact a qualified person.

**WARNING** - Install these kits only in the luminaires that has the construction features and dimensions shown in the photographs and/or drawings.

#### Retrofit Kit Contents

LED Fixture  
LED Driver Box  
3 - Retaining Clips



### Housing Compatibility

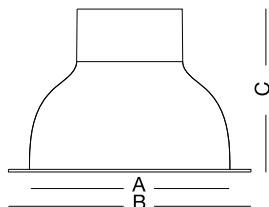

Model No.	A	B	C
DCL10D-NW40	10.05" (255.27 mm)	11.65" (295.91 mm)	9.53" (242.06 mm)
DCL8D-NW40	7.9" (200.66 mm)	9.53" (242.06 mm)	8.45" (214.63 mm)

### Installation Instructions

**NOTE: RETROFIT KIT IS VOLTAGE SPECIFIC. VERIFY VOLTAGE IS 100~277 BEFORE INSTALLATION**

1. Remove power to fixture, then remove existing lamp.
2. Remove and discard existing reflector from mounting frame.
3. Open junction box.
4. Cut all supply wires leading to the ballast. (wires may be removed)
5. Twist out conduit knockout.
6. Place LED Driver box through ceiling cut-out and allow to rest on ceiling.
7. Install driver box supply conduit into the junction box.
8. Connect the supply voltage to LED driver. Black to line, white to neutral.
9. Connect green to ground, close junction box. If using 0~10V dimmer, open driver box and make connections gray to gray, purple to purple.
10. Push reflector up through existing mounting frame. If fixture is loose, install 3 retaining clips on mounting frame.

