

Important: Read all instructions prior to installation.

11" Flush Mount LED Ceiling Light

Included Parts

1 - Flush Mount LED Ceiling Light

Safety and Notes

- Product should be installed in accordance with applicable national, state, and local building and electrical codes.
- To reduce the risk of electric shock, ensure that the main power source and circuit breakers are switched off before performing any installation or wiring procedures.
- Avoid looking directly into the lamp when illuminated.
- Ensure all mounts are securely attached. Failure to properly support the fixture may result in damage or injury, for which the manufacturer does not assume responsibility.

Specifications

CLD-xK12-WM	
Power Consumption	12 W
Operating Voltage Range	120 VAC
Beam Angle	180 degree
Current Draw	0.1 A
Operating Temperature	-4°–113° F (-20°–45° C)
IP Rating	dry or damp location
Dimmable	TRIAC
Fixture Weight	10 oz (0.3 kg)

Installation

1. Thread screws into junction box leaving a 1/16" gap between box and screw head.
2. Remove lens from light by rotating counterclockwise.
3. Connect wiring.
4. Place light over screw heads and rotate so that light is held up by screw heads.
5. Tighten screws to secure light.
6. Reinstall lens.

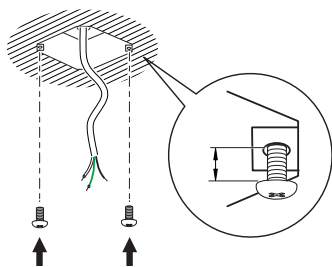

1

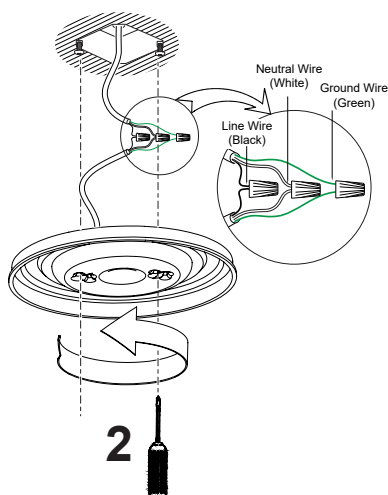

2

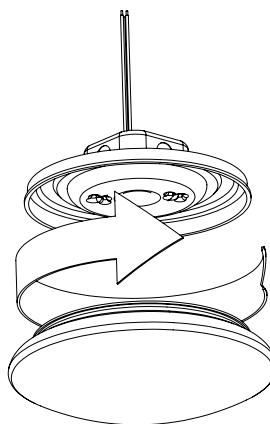

3

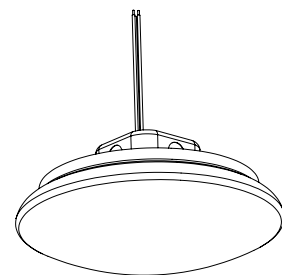

4

Important: Read all instructions prior to installation.

11" Flush Mount LED Ceiling Light

Dimensional Diagrams

